

3400 DUFFERIN STREET

APPLICATION FOR ZONING BY-LAW AMENDMENT & SITE PLAN CONTROL

PROJECT TEAM

DEVELOPER
 CollecDev
 20 Eglinton Ave W, Suite 1700
 Toronto, ON, M4R 1K3
 T: 416-640-6000
 collecdev.com

ARCHITECTURAL & LANDSCAPE ARCHITECTURE
 gh3*
 T: 416-915-1791
 gh3.ca

PLANNING & URBAN DESIGN
 Bouzfields
 T: 416-947-9744
 bouzfields.ca

CIVIL ENGINEERING
 IBI GROUP
 T: 905-763-2322
 ibigroup.com

WIND & ARBORIST
 SLR Consulting
 T: 226-706-8080
 slrconsulting.com

TRANSPORTATION
 BA GROUP
 T: 416-961-7110
 bagroup.com

STRUCTURAL
 TBD

MECHANICAL & ELECTRICAL
 TBD

LANDSCAPE SHEET LIST

Sheet	Drawing Name	Current Revision
L000 PROJECT INFORMATION		
L000	COVER PAGE	1
L100 PLANS		
L101	LANDSCAPE PLAN	1
L102	LANDSCAPE ROOF PLANS	1
L103	PLANTING & SOIL VOLUME PLAN	1
L200 SECTIONS		
L201	STREETSCAPE PLAN & SECTIONS	1
L202	STREETSCAPE PLAN & SECTIONS	1
L400 DETAILS		
L401	LANDSCAPE DETAILS	1
L402	LANDSCAPE DETAILS	1
L403	COT TYP DETAILS	1
LE100 PLANS		
LE101	LEVEL 1 LIGHTING PLAN	1
LE102	LEVEL 7 LIGHTING PLAN	1
LE103	LEVEL 8 LIGHTING PLAN	1



Copyright is that of the Architect. Any version of this drawing reproduced by any means from any media without prior written approval of the Architect is to be read for information only.

The Architect is not liable for any loss or distortion of information resulting from subsequent reproduction of the original drawing.

GENERAL NOTES:

1. Drawings are not to be scaled. Contractor will verify all existing conditions and dimensions against the drawings and will report any discrepancies with the Contract Documents to the Architect before commencing work.
2. The Architectural Drawings are to be read in conjunction with all other Contract Documents including the Project Manual and the Structural, Mechanical and Electrical Drawings. In case of difference between the Contractor's documents with respect to the quantity, sizes or scope of work, the greater shall apply.
3. Positions of existing or finished Mechanical or Electrical devices, fittings and valves are indicated on the Architectural Drawings. Locations shown on the Architectural Drawings shall govern over Mechanical and Electrical Drawings. Mechanical and Electrical items not clearly located will be located as directed by the Architect.
4. Dimensions indicated on plans between the faces of finished surfaces unless otherwise noted.
5. The architect has not been retained for supervision of construction and assumes no responsibility for means, methods and techniques of construction.
6. These documents are not to be used for construction unless specifically noted for such purpose.

1 Aug 09, 2022 ISSUE FOR ZBA & SPA
 Rev. Date Issue#



gh3
 gh3*
 55 OSSINGTON AVE, SUITE 100
 Toronto, ON, Canada M5J 2Y9
 416-915-1791

COLLECDEV
 3400 DUFFERIN STREET

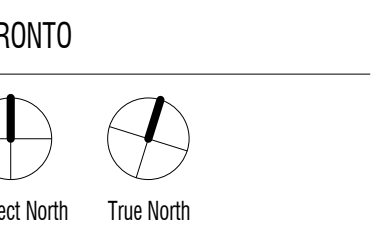

SCALE
 PROJECT NO. 202211
 ISSUE DATE

COVER PAGE

L000

Copyright is that of the Architect. Any reuse of this drawing reproduced by any means from any media without prior written approval of the Architect is to be read for information only.

The Architect is not liable for any loss or damage of information resulting from subsequent reproduction of the original drawing.

GENERAL NOTES:

- Drawings are not to be scaled. Contractor will verify all existing conditions and dimensions required to perform the Work and will report any discrepancies with the Contract Documents to the Architect before commencing work.
- The Architectural Drawings are to be read in conjunction with all other Contract Documents including the Project Manual and the Structural, Mechanical and Electrical Drawings. In cases of difference between the Contract Documents with respect to the quantity, uses or scope of work, the greater shall apply.
- Positions of proposed Mechanical or Electrical devices, Ropes and Poles are indicated on the Architectural Drawings. Locations shown on the Architectural Drawings shall govern over Mechanical and Electrical Drawings. Mechanical and Electrical items not clearly located will be located as directed by the Architect.
- Dimensions indicated are taken between the faces of finished surfaces unless otherwise noted.
- The Architect has not been retained for supervision of construction and assumes no responsibility for means, methods and techniques of construction.
- These documents are not to be used for construction unless specifically noted for such purpose.

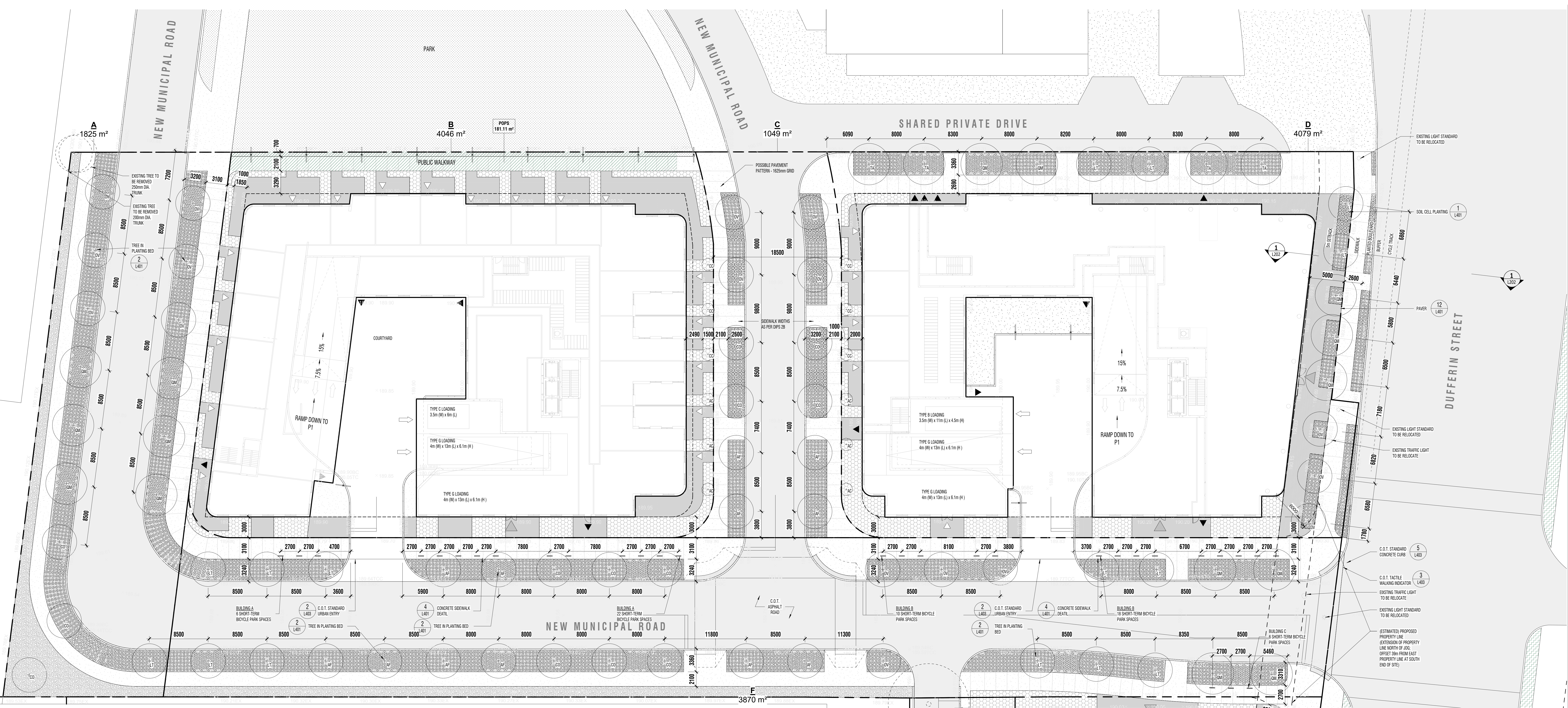

3 GROUND FLOOR LANDSCAPE PLAN
A300 L101 1:200

PLANTING SCHEDULE - TREES*

SYM	TAG	COMMON NAME	BOTANICAL NAME	SIZE	CONDITION	QTY	REMARKS
AC	SERVICEBERRY	AMELANCHIER CANADENSIS	200 cm ht. multi-stemmed	WB	6	FLOWERING, DROUGHT TOLERANT, NATIVE SPECIES	
AF	FREEMAN MAPLE	ACER x FREEMANII	80mm CAL.	WB	17	DROUGHT TOLERANT, NATIVE SPECIES	
CC	REDBUD	CERCIS CANADENSIS	200 cm ht. multi-stemmed	WB	6	FLOWERING, DROUGHT TOLERANT, NATIVE SPECIES	
CO	HACKBERRY	CELTIS OCCIDENTALIS	80mm CAL.	WB	17	DROUGHT TOLERANT, NATIVE SPECIES	
LT	TULIP POPLAR	LIRIODENDRON TULIPIFERA	80mm CAL.	WB	15	DROUGHT TOLERANT, NATIVE SPECIES	
OV	HOPHORNBEAM	OSTRYA VIRGINIANA	80mm CAL.	WB	17	DROUGHT TOLERANT, NATIVE SPECIES	
QM	BURR OAK	QUERCUS MACROCARPA	80mm CAL.	WB	15	DROUGHT TOLERANT, NATIVE SPECIES	
TA	AMERICAN BASSWOOD	TILIA AMERICANA	80mm CAL.	WB	8	DROUGHT TOLERANT, NATIVE SPECIES	

SOFTSCAPE AREAS

TYPE	AREA
HEDGES + SHRUB	688 m ²
PLANTER- DC + JT + ER + CA	2209 m ²
TOTAL	2907 m²

SOIL VOLUME FOR TREE PLANTING

PLANTING AREA	DEPTH	SOIL VOLUME	NO. OF TREES	SOIL VOLUME/TREE	
1	206 m ²	1.2 m	2465 m ³	8	308.1 m ³
2	232 m ²	1.2 m	2784 m ³	9	309.3 m ³
3	126 m ²	1.2 m	151.6 m ³	5	30.3 m ³
4	309 m ²	1.2 m	371.2 m ³	12	30.9 m ³
5	204 m ²	1.2 m	244.8 m ³	12	20.4 m ³
6	78 m ²	1.2 m	93.6 m ³	3	30.2 m ³
7	114 m ²	1.2 m	136.8 m ³	4	34.2 m ³
8	205 m ²	1.2 m	246.0 m ³	8	30.8 m ³
9	251 m ²	1.2 m	301.2 m ³	8	37.6 m ³
10	127 m ²	1.2 m	152.4 m ³	5	30.5 m ³
11	289 m ²	1.2 m	346.8 m ³	8	43.3 m ³
12	126 m ²	1.2 m	151.2 m ³	5	30.2 m ³
13	25 m ²	1.2 m	30.0 m ³	1	30.0 m ³
14	247 m ²	1.2 m	296.4 m ³	10	29.6 m ³
15	77 m ²	1.2 m	92.4 m ³	3	30.8 m ³
TOTALS: 15	2548 m²		3165.1 m³	191	30.8 m³

PLANTING SCHEDULE - SHRUBS & VINES*

TAG	COMMON NAME	BOTANICAL NAME	Size	CONDITION	QTY	REMARKS
CA	AWNED SEDGE	CAREX ATHERODES	2 GAL.	CONT.	1280	500mm O.C. DROUGHT TOLERANT, NATIVE SPECIES
DC	TUFTED HAIR GRASS	DESCHAMPSIA DESIPITOSA	2 GAL.	POTTED	2040	500mm O.C. DROUGHT TOLERANT, NATIVE SPECIES
ER	RIVER WILD-RYE	ELYMUS RIPARIUS	2 GAL.	CONT.	1562	500mm O.C. DROUGHT TOLERANT, NATIVE SPECIES
JT	PATH RUSH	JUNCUS TENUIS	2 GAL.	CONT.	2427	500mm O.C. DROUGHT TOLERANT, NATIVE SPECIES

LEGEND:

- HIGH-ALBEDO PAVERS SRI VALUE: 20 OR BETTER
- CONCRETE PAVING SRI VALUE: 20 OR BETTER
- CONCRETE PAVING SRI VALUE: 20 OR BETTER
- CONCRETE PAVING SRI VALUE: 20 OR BETTER
- BICYCLE LANE
- SID
- BLACK MULCH
- RUBBERIZED PAVING
- WOOD DECKING SRI VALUE: 20 OR BETTER
- ARTIFICIAL TURF GRASS / COOL-RELIEF AREA

NOTES:

A TREE WATERING PROGRAM IS TO BE PROVIDED FOR A MINIMUM OF FOUR (4) YEARS AFTER PLANTING.

MINIMUM 75% OF TOTAL HARDSCAPE AREA WILL BE OF HIGH-ALBEDO PAVING MATERIALS WITH AN INTRINSIC SOLAR REFLECTANCE OF AT LEAST 0.33 OR SRI OF 25.

A NON-PORTABLE WATER IRRIGATION SYSTEM WILL BE USED.

1 Aug 09, 2022 ISSUE FOR 2BA & 3PA
Rev. Date Issued



gh3
35 OSSINGTON AVE., SUITE 100
TORONTO, ON, CANADA M5J 2Y9
416 915 1791

COLLECTEV
3400 DUFFERIN STREET

TORONTO
Project North True North

SCALE As indicated
PROJECT NO. 202211
ISSUE DATE

LANDSCAPE PLAN

L101

Copyright is that of the Architect. Any version of this drawing reproduced by any means from any media without prior written approval of the Architect is to be held for information only.

The Architect is not liable for any loss or disturbance of information resulting from subsequent reproduction of the original drawings.

GENERAL NOTES:

- Drawings are not to be scaled. Contractor will verify all existing conditions and dimensions against the Project Manual and will report any discrepancies with the Contract Documents to the Architect before commencing work.
- The Architectural Drawings are to be read in conjunction with all other Contract Documents including the Project Manual and the Structural, Mechanical and Electrical Drawings. In case of difference between the Contractor documents with respect to the quantity, sizes or scope of work, the greater shall apply.
- Positions of exposed or finished Mechanical or Electrical devices, fittings and valves are indicated on the Architectural Drawings. Locations shown on the Architectural Drawings shall govern over Mechanical and Electrical Drawings. Mechanical and Electrical items not clearly located will be located as directed by the Architect.
- Dimensions indicated on plans between the faces of finished surfaces unless otherwise noted.
- The Architect has not been retained for supervision of construction and assumes no responsibility for means, methods and techniques of construction.
- These documents are not to be used for construction unless specifically noted for such purpose.

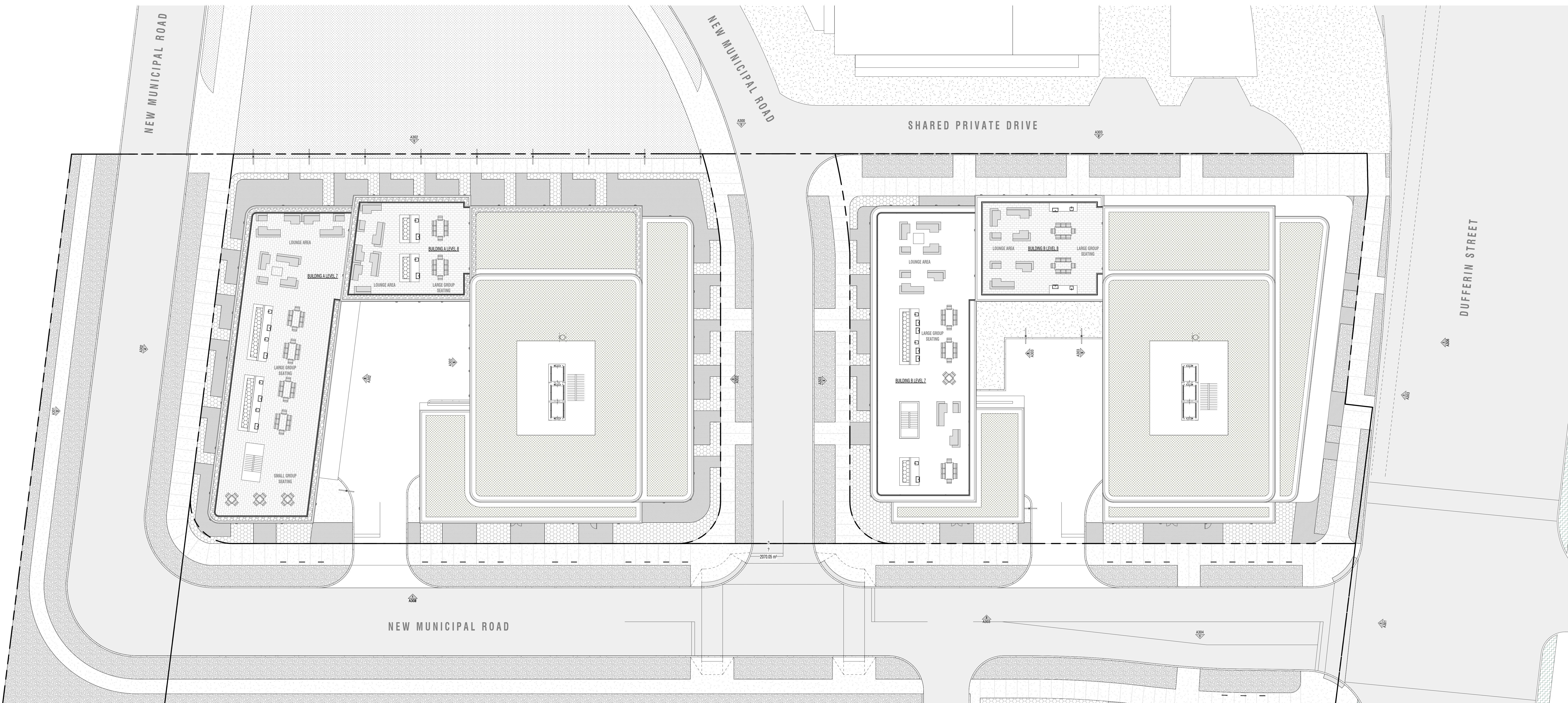

1 MPH Roof
A300 L102 1:200

PLANTING SCHEDULE - TREES*

SYM	TAG	COMMON NAME	BOTANICAL NAME	SIZE	CONDITION	QTY	REMARKS
AC	SERVICEBERRY	AMELANCHIER CANADENSIS	200 cm ht. multi-stemmed	WB	6	FLOWERING; DROUGHT TOLERANT; NATIVE SPECIES	
AF	FREEMAN MAPLE	ACER x FREEMANII	80mm CAL.	WB	17	DROUGHT TOLERANT; NATIVE SPECIES	
CC	REDBUD	CERCIS CANADENSIS	200 cm ht. multi-stemmed	WB	6	FLOWERING; DROUGHT TOLERANT; NATIVE SPECIES	
CO	HACKBERRY	CELTIS OCCIDENTALIS	80mm CAL.	WB	17	DROUGHT TOLERANT; NATIVE SPECIES	
LT	TULIP POPLAR	LIRIODENDRON TULIPIFERA	80mm CAL.	WB	15	DROUGHT TOLERANT; NATIVE SPECIES	
OV	HOPHORNBEAM	OSTRYA VIRGINIANA	80mm CAL.	WB	17	DROUGHT TOLERANT; NATIVE SPECIES	
QM	BURR OAK	QUERCUS MACROCARPA	80mm CAL.	WB	15	DROUGHT TOLERANT; NATIVE SPECIES	
TA	AMERICAN BASSWOOD	TILIA AMERICANA	80mm CAL.	WB	8	DROUGHT TOLERANT; NATIVE SPECIES	

SOFTSCAPE AREAS

TYPE	AREA
Level 1 HEDGES + SHRUB	688 m ²
PLANTER- DC + JT + ER + CA	2209 m ²
	2907 m ²
TOTAL	2907 m²

SOIL VOLUME FOR TREE PLANTING

PLANTING AREA	AREA	DEPTH	SOIL VOLUME	NO. OF TREES	SOIL VOLUME / TREE
1	298 m ²	1.2 m	246.9 m ³	8	30.9 m ³
2	232 m ²	1.2 m	278.4 m ³	9	30.9 m ³
3	126 m ²	1.2 m	151.6 m ³	5	30.3 m ³
4	389 m ²	1.2 m	471.2 m ³	12	39.3 m ³
5	384 m ²	1.2 m	464.4 m ³	12	38.7 m ³
6	78 m ²	1.2 m	93.6 m ³	3	31.2 m ³
7	114 m ²	1.2 m	136.7 m ³	4	34.2 m ³
8	205 m ²	1.2 m	246.0 m ³	8	30.8 m ³
9	201 m ²	1.2 m	241.2 m ³	8	30.1 m ³
10	127 m ²	1.2 m	152.4 m ³	5	30.5 m ³
11	203 m ²	1.2 m	243.6 m ³	8	30.5 m ³
12	126 m ²	1.2 m	151.2 m ³	5	30.2 m ³
13	25 m ²	1.2 m	30.0 m ³	1	30.0 m ³
14	257 m ²	1.2 m	308.4 m ³	10	30.8 m ³
15	77 m ²	1.2 m	92.4 m ³	3	30.8 m ³
TOTAL: 15	2588 m²		3165.3 m³	101	

PLANTING SCHEDULE - SHRUBS & VINES*

TAG	COMMON NAME	BOTANICAL NAME	Size	CONDITION	QTY	REMARKS
CA	AWNED SEDGE	CAREX ATHERODES	2 GAL.	CONT.	1280	500mm O.C. DROUGHT TOLERANT; NATIVE SPECIES
DC	TUFTED HAIR GRASS	DESCHAMPISIA CESPITOSA	2 GAL.	POTTED	2040	500mm O.C. DROUGHT TOLERANT; NATIVE SPECIES
ER	RIVER WILD-RYE	ELYMUS RIPARIUS	2 GAL.	CONT.	1562	500mm O.C. DROUGHT TOLERANT; NATIVE SPECIES
JT	PATH RUSH	JUNCUS TENUIS	2 GAL.	CONT.	2427	500mm O.C. DROUGHT TOLERANT; NATIVE SPECIES

- HIGH-ALBEDO PAVERS
SRI VALUE: 29 OR BETTER
- CONCRETE PAVING
SRI VALUE: 29 OR BETTER
- CONCRETE PAVING
SRI VALUE: 29 OR BETTER
- BICYCLE LANE
- SOD
- BLACK MULCH
- RUBBERIZED PAVING
- WOOD DECKING SRI VALUE: 29 OR BETTER
- ARTIFICIAL TURF GRASS / SOD RELIEF AREA

NOTES

A TREE WATERING PROGRAM IS TO BE PROVIDED FOR A MINIMUM OF FOUR (4) YEARS AFTER PLANTING.

MINIMUM 75% OF TOTAL HARDSCAPE AREA WILL BE OF HIGH-ALBEDO FINISH MATERIAL WITH AN INITIAL SOLAR REFLECTANCE OF AT LEAST 0.33 OR SRI OF 29.

A NON-PORTABLE WATER IRRIGATION SYSTEM WILL BE USED

1 Aug 09, 2022 ISSUE FOR ZBA & SPA
Rev. Date Issue



gh3
gh3*
55 OSSINGTON AVE. SUITE 100
Toronto, ON, Canada M5G 2Y9
416 915 1701

COLLECTDEV
3400 DUFFERIN STREET

TORONTO
Project North True North

SCALE As indicated
PROJECT NO. 202211
ISSUE DATE

LANDSCAPE ROOF PLANS

Copyright is that of the Architect. Any version of this drawing reproduced by any means from any media without prior written approval of the Architect is to be held for information only.

The Architect is not liable for any loss or disturbance of information resulting from subsequent reproduction of the original drawings.

GENERAL NOTES:

- Drawings are not to be scaled. Contractor will verify all existing conditions and dimensions required to perform the work and will report any discrepancies with the Contract Documents to the Architect before commencing work.
- The Architectural Drawings are to be read in conjunction with all other Contract Documents including the Project Manual and the Structural, Mechanical and Electrical Drawings. In cases of difference between the Contract Documents with respect to the quantity, sizes or scope of work, the greater shall apply.
- Positions of proposed or retained Mechanical or Electrical devices, fittings and valves are indicated on the Architectural Drawings. Locations shown on the Architectural Drawings shall govern over Mechanical and Electrical Drawings. Mechanical and Electrical items not clearly located will be located as directed by the Architect.
- Dimensions indicated on plans between the faces of finished surfaces unless otherwise noted.
- The Architect has not been retained for supervision of construction and assumes no responsibility for means, methods and techniques of construction.
- These documents are not to be used for construction unless specifically noted for such purpose.

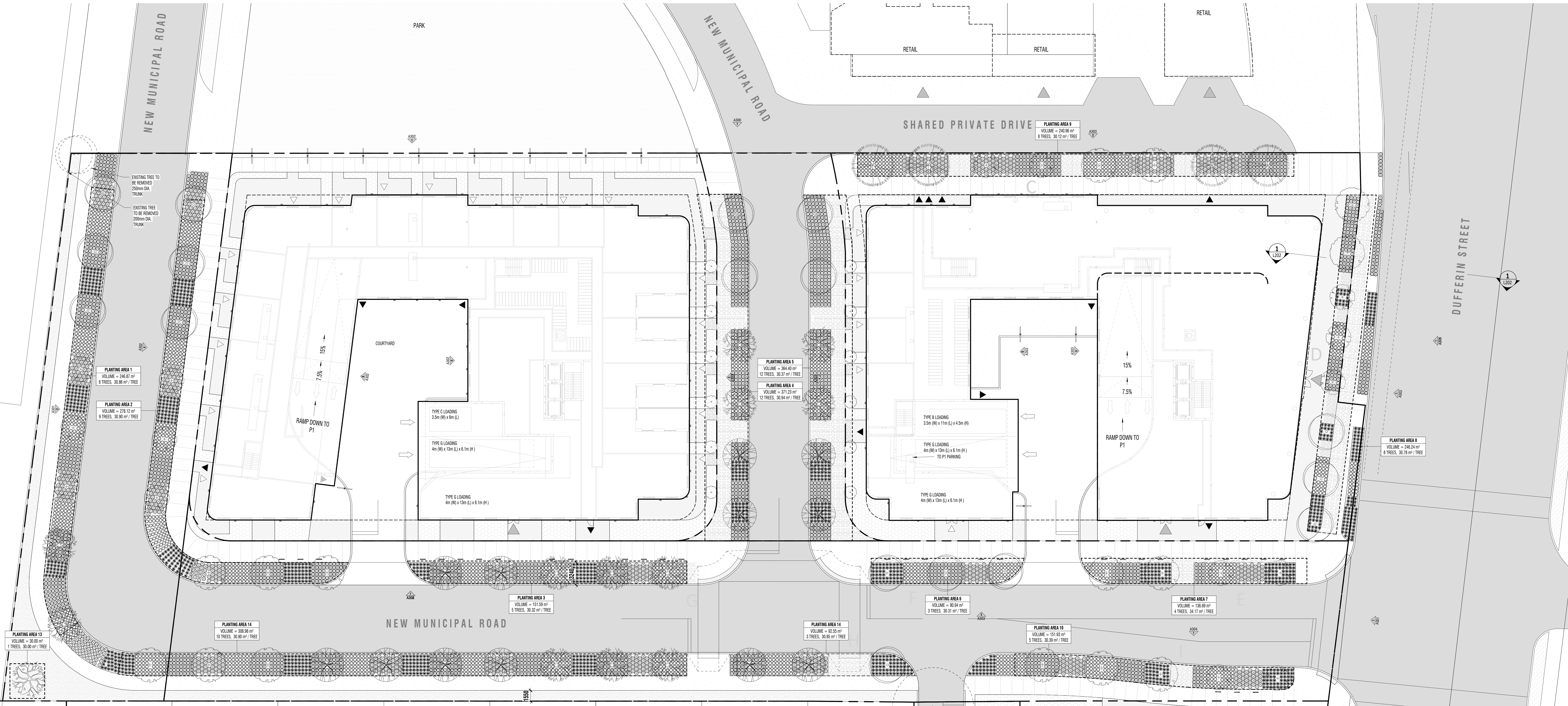

1 GROUND FLOOR PLANTING & SOIL PLAN
A300 L103 1:200

PLANTING SCHEDULE - TREES*

SYM	TAG	COMMON NAME	BOTANICAL NAME	SIZE	CONDITION	QTY	REMARKS
Level 1							
AC	SERVICEBERRY	AMELANCHIER CANADENSIS	200 cm ht. multi-stemmed	WB	6	FLOWERING; DROUGHT TOLERANT; NATIVE SPECIES	
AF	FREEMAN MAPLE	ACER x FREEMANII	80mm CAL.	WB	17	DROUGHT TOLERANT; NATIVE SPECIES	
CC	REDBUD	CERCIS CANADENSIS	200 cm ht. multi-stemmed	WB	6	FLOWERING; DROUGHT TOLERANT; NATIVE SPECIES	
CO	HACKBERRY	CELTIS OCCIDENTALIS	80mm CAL.	WB	17	DROUGHT TOLERANT; NATIVE SPECIES	
LT	TULIP POPLAR	LIRIODENDRON TULPIFERA	80mm CAL.	WB	15	DROUGHT TOLERANT; NATIVE SPECIES	
OV	HOPHORNBEAM	OSTRYA VIRGINIANA	80mm CAL.	WB	17	DROUGHT TOLERANT; NATIVE SPECIES	
QM	BURR OAK	QUERCUS MACROCARPA	80mm CAL.	WB	15	DROUGHT TOLERANT; NATIVE SPECIES	
TA	AMERICAN BASSWOOD	TILIA AMERICANA	80mm CAL.	WB	8	DROUGHT TOLERANT; NATIVE SPECIES	

SOFTSCAPE AREAS

TYPE	AREA
Level 1	
HEDGES + SHRUB	688 m ²
PLANTER- DC + JT + ER + CA	2209 m ²
TOTAL	2907 m ²

SOIL VOLUME FOR TREE PLANTING

PLANTING AREA	AREA	DEPTH	SOIL VOLUME	NO. OF TREES	SOIL VOLUME / TREE
1	298 m ²	1.2 m	246.9 m ³	8	30.9 m ³
2	232 m ²	1.2 m	278.4 m ³	9	30.9 m ³
3	126 m ²	1.2 m	151.6 m ³	5	30.3 m ³
4	389 m ²	1.2 m	371.2 m ³	12	30.9 m ³
5	384 m ²	1.2 m	384.0 m ³	12	32.0 m ³
6	78 m ²	1.2 m	90.0 m ³	3	30.0 m ³
7	114 m ²	1.2 m	136.7 m ³	4	34.2 m ³
8	205 m ²	1.2 m	246.2 m ³	8	30.8 m ³
9	201 m ²	1.2 m	241.2 m ³	8	30.1 m ³
10	127 m ²	1.2 m	151.9 m ³	5	30.4 m ³
11	203 m ²	1.2 m	243.6 m ³	8	30.5 m ³
12	128 m ²	1.2 m	153.6 m ³	5	30.7 m ³
13	25 m ²	1.2 m	30.0 m ³	1	30.0 m ³
14	257 m ²	1.2 m	308.0 m ³	10	30.8 m ³
14	77 m ²	1.2 m	92.4 m ³	3	30.8 m ³
TOTALS	14	588 m ²	716.5 m ³	140	

PLANTING SCHEDULE - SHRUBS & VINES*

TAG	COMMON NAME	BOTANICAL NAME	Size	CONDITION	QTY	REMARKS
Level 1						
CA	AWNED SEDGE	CAREX ATHERODES	2 GAL.	CONT.	1280	500mm O.C. DROUGHT TOLERANT; NATIVE SPECIES
DC	TUFTED HAIR GRASS	DESCHAMPSIA DESPITOSA	2 GAL.	POTTED	2040	500mm O.C. DROUGHT TOLERANT; NATIVE SPECIES
ER	RIVER WILD-RYE	ELYMUS RIPARIUS	2 GAL.	CONT.	1562	500mm O.C. DROUGHT TOLERANT; NATIVE SPECIES
JT	PATH RUSH	JUNCUS TENUIS	2 GAL.	CONT.	2427	500mm O.C. DROUGHT TOLERANT; NATIVE SPECIES

LEGEND

- HIGH-ALBEDO PAVERS SRI VALUE: 29 OR BETTER
- CONCRETE PAVING SRI VALUE: 29 OR BETTER
- CONCRETE PAVING SRI VALUE: 29 OR BETTER
- BICYCLE LANE
- SOD
- BLACK MULCH
- RUBBERIZED PAVING
- WOOD DECKING SRI VALUE: 29 OR BETTER
- ARTIFICIAL TURF GRASS / SOD RELIEF AREA

NOTES

A TREE WATERING PROGRAM IS TO BE PROVIDED FOR A MINIMUM OF FOUR (4) YEARS AFTER PLANTING.

MINIMUM 75% OF TOTAL HARDSCAPE AREA SHALL BE OF HIGH-ALBEDO PAVING MATERIALS WITH AN MINIMAL SOLAR REFLECTANCE OF AT LEAST 0.33 OR SRI OF 26.

A NON-PORTABLE WATER IRRIGATION SYSTEM WILL BE USED.

1 Aug 09, 2022 ISSUE FOR ZBA & SPA
Rev. Date Issue



gh3
gh3*
55 OSSINGTON AVE. SUITE 100
TORONTO, ON, CANADA M5J 2Y9
416 915 1701

COLLECTDEV
3400 DUFFERIN STREET

TORONTO
Project North True North

SCALE As indicated
PROJECT NO. 202211
ISSUE DATE

PLANTING & SOIL VOLUME PLAN
L103

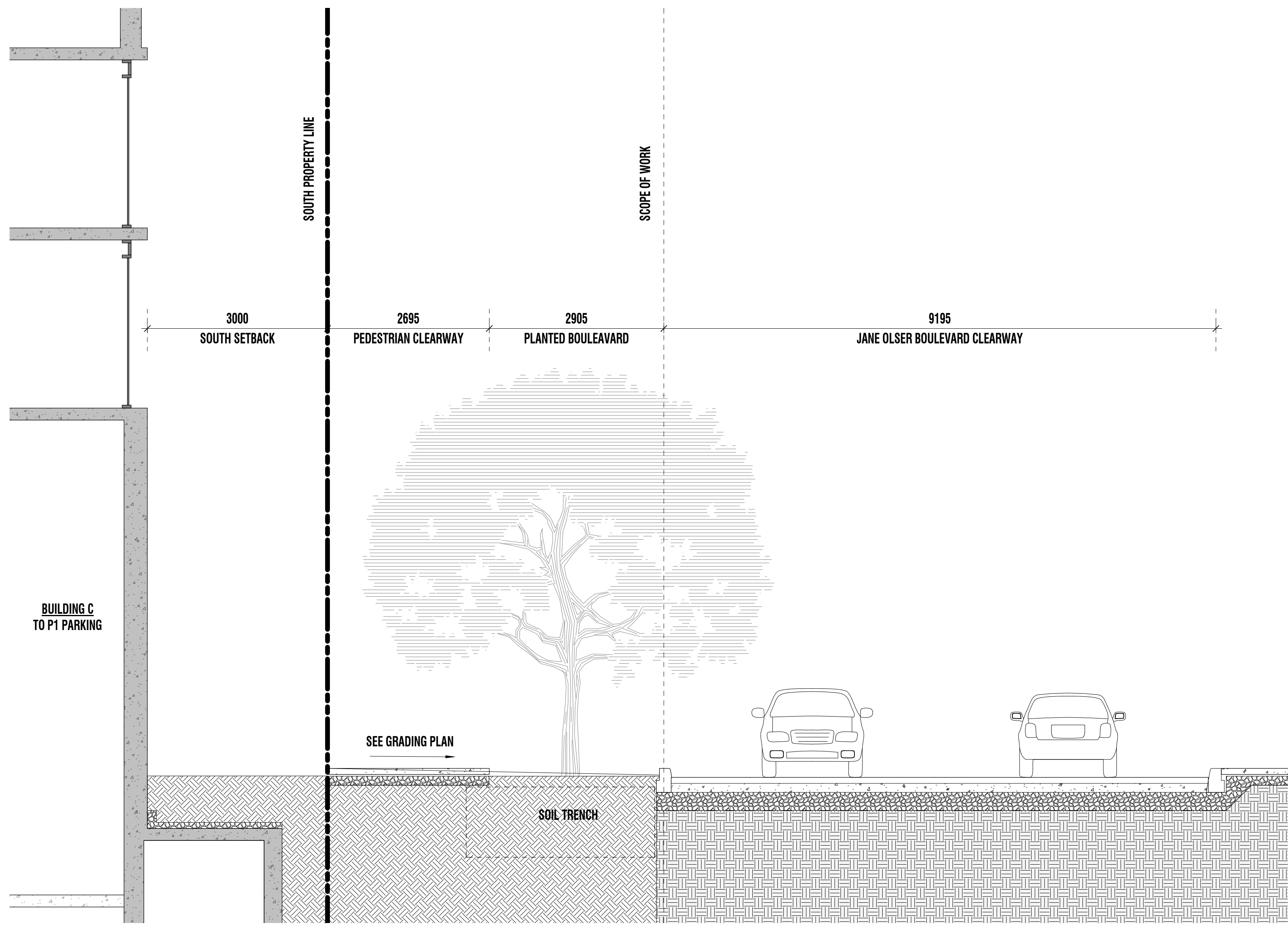

1 STREETScape SECTION 1
L101 L201 1:50

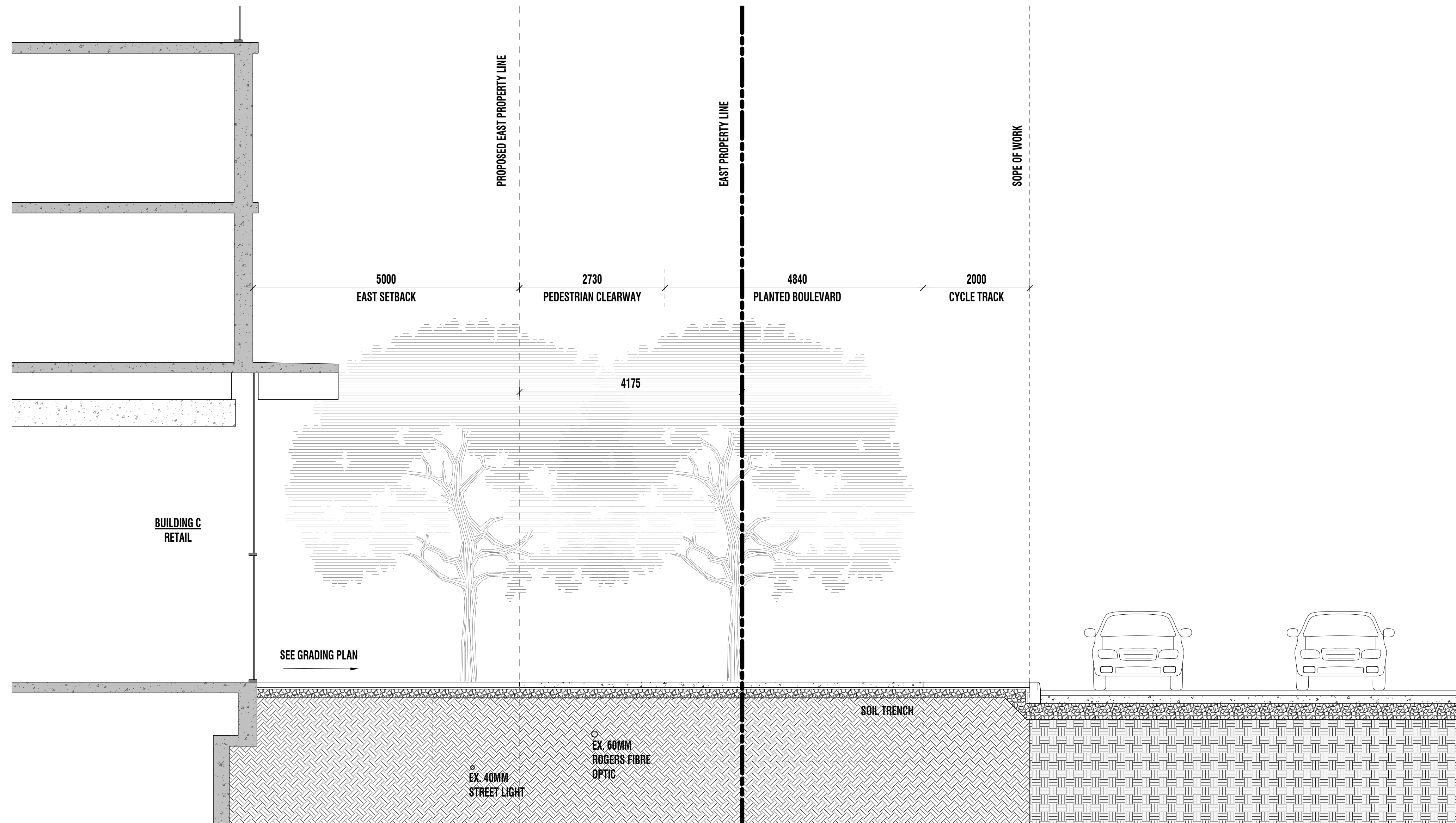

2 STREETScape SECTION 2
L101 L201 1:50

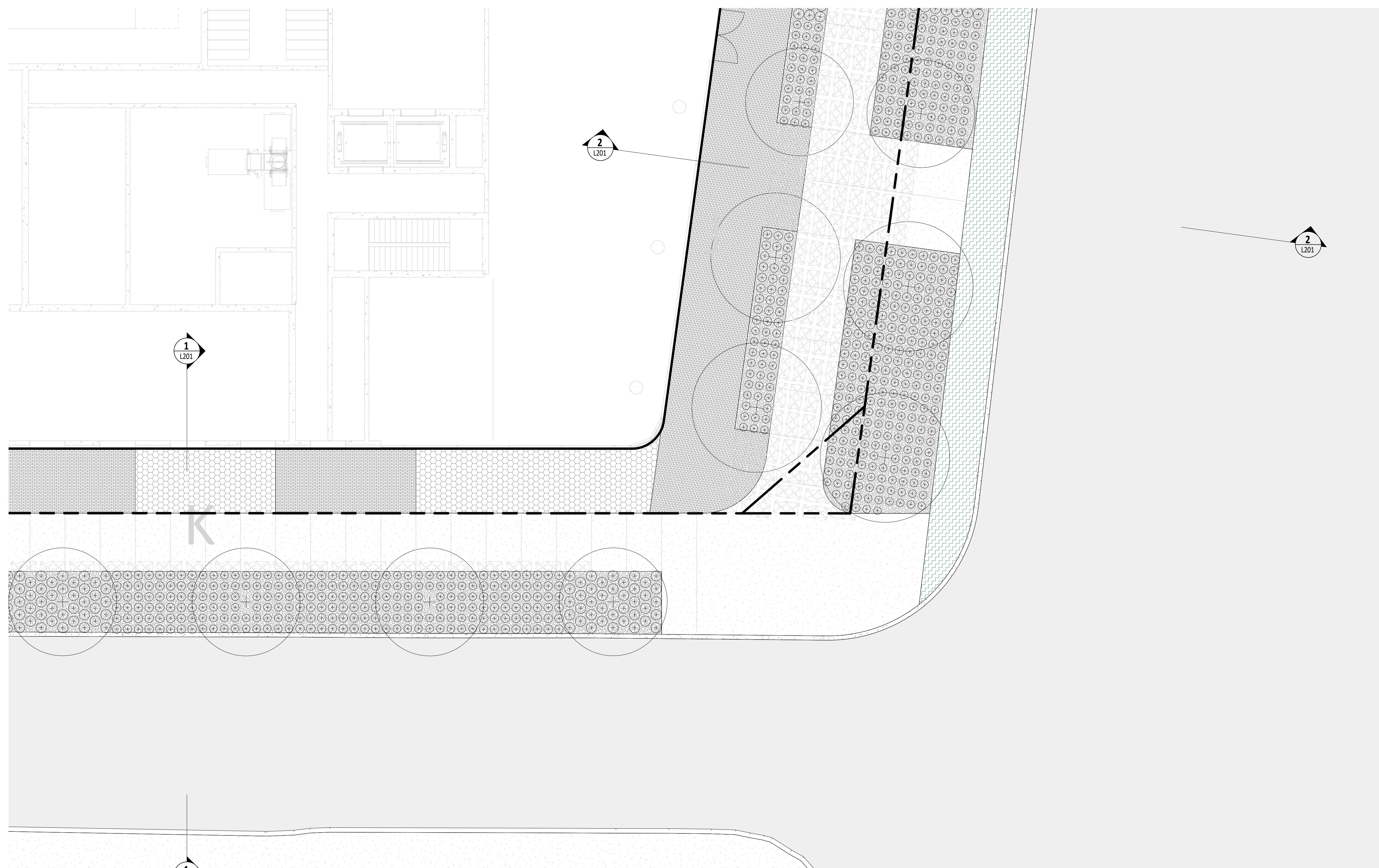

3 STREETScape BUILDING C PLAN
A300 L201 1:100

Copyright is that of the Architect.
Any version of this drawing reproduced by any means from any media without prior written approval of the Architect is to be read for information only.
The Architect is not liable for any loss or distortion of information resulting from subsequent reproduction of the original drawing.
GENERAL NOTES:
1. Drawings are not to be scaled. Contractor will verify all existing conditions and dimensions required to perform the work and will report any discrepancies with the Contract Documents to the Architect before commencing work.
2. The Architectural Drawings are to be read in conjunction with all other Contract Documents including the Project Manual and the Structural, Mechanical and Electrical Drawings. In cases of difference between the Contract Documents with respect to the quantity, sizes or scope of work, the greater shall apply.
3. Positions of exposed or finished Mechanical or Electrical devices, fittings and valves are indicated on the Architectural Drawings. Locations shown on the Architectural Drawings shall govern over Mechanical and Electrical Drawings. Mechanical and Electrical items not clearly located will be located as directed by the Architect.
4. Dimensions indicated on plans between the faces of finished surfaces unless otherwise noted.
5. The Architect has not been retained for supervision of construction and assumes no responsibility for means, methods and techniques of construction.
6. These documents are not to be used for construction unless specifically noted for such purpose.

1 Aug 09, 2022 ISSUE FOR E&A & SPA
Rev. Date Issue



gh3
gh3*
55 OSSINGTON AVE, SUITE 100
TORONTO, ON, CANADA M5J 2Y9
416 915 1791

COLLECDEV
3400 DUFFERIN STREET

TORONTO
Project North True North

SCALE As Indicated
PROJECT NO. 202211
ISSUE DATE

**STREETScape
PLAN &
SECTIONS
L201**

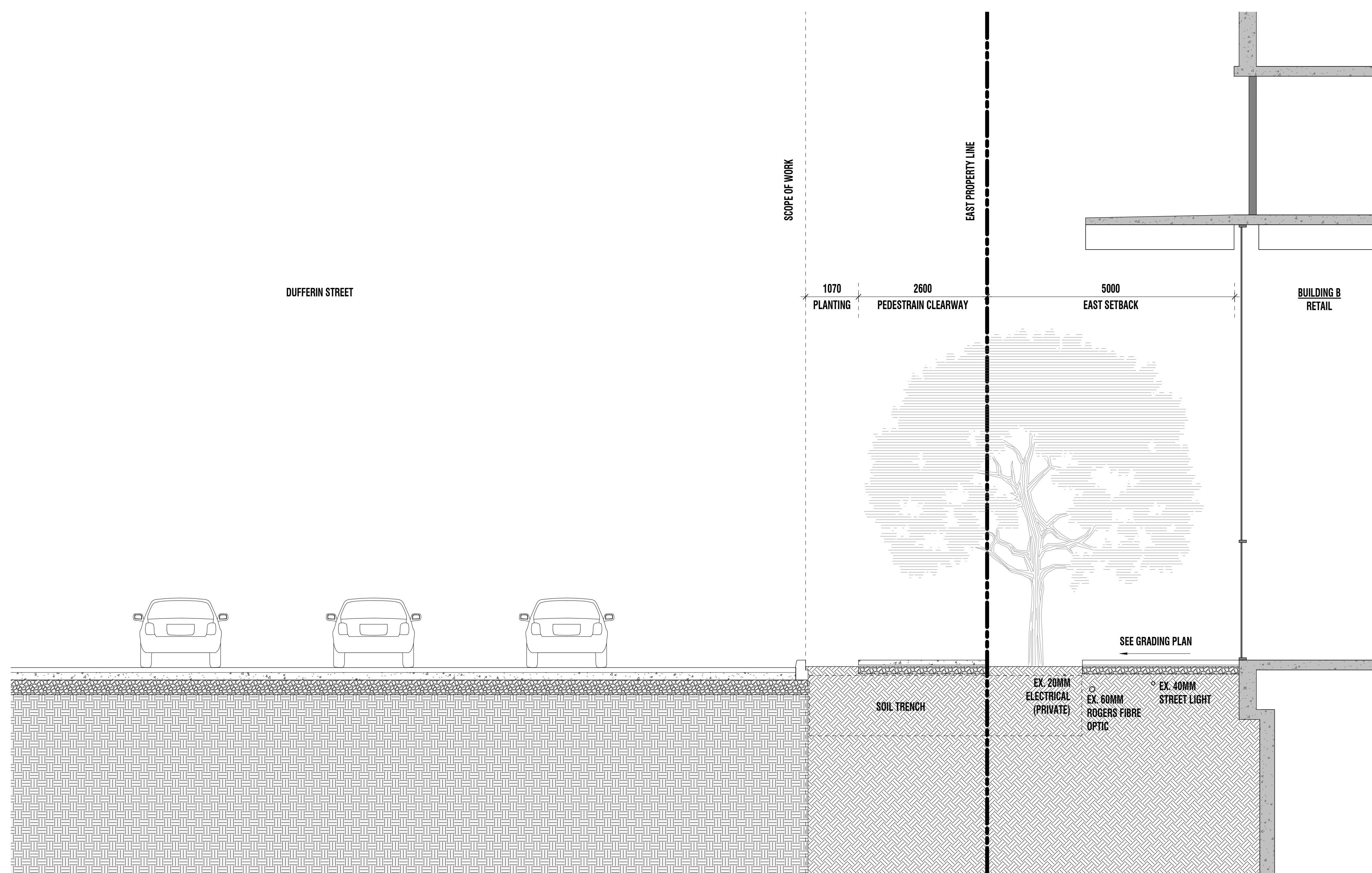

1 STREETScape SECTION 3
L101 L202 1 : 50



2 STREETScape BUILDING B PLAN
A300 L202 1 : 100

Copyright is that of the Architect.
Any version of this drawing reproduced by any means from any media without prior written approval of the Architect is to be used for information only.
The Architect is not liable for any loss or distortion of information resulting from subsequent reproduction of the original drawing.

GENERAL NOTES:

1. Drawings are not to be scaled. Contractor will verify all existing conditions and dimensions required to perform the work and will report any discrepancies with the Contract Documents to the Architect before commencing work.
2. The Architectural Drawings are to be read in conjunction with all other Contract Documents including the Project Manual and the Structural, Mechanical and Electrical Drawings. In cases of difference between the Contract Documents with respect to the quantity, sizes or scope of work, the greater shall apply.
3. Positions of proposed finished Mechanical or Electrical devices, fittings and valves are indicated on the Architectural Drawings. Locations shown on the Architectural Drawings shall govern over Mechanical and Electrical Drawings. Mechanical and Electrical items not clearly located will be located as directed by the Architect.
4. Dimensions indicated on plans between the faces of finished surfaces unless otherwise noted.
5. The architect has not been retained for supervision of construction and assumes no responsibility for means, methods and techniques of construction.
6. These documents are not to be used for construction unless specifically noted for such purpose.

1 Aug 09, 2022 ISSUE FOR RBA & SPA
Rev. Date Issue



gh3
gh3*
55 OSSINGTON AVE, SUITE 100
TORONTO, ON, CANADA M5J 2Y9
416 915 1791

COLLECDEV
3400 DUFFERIN STREET

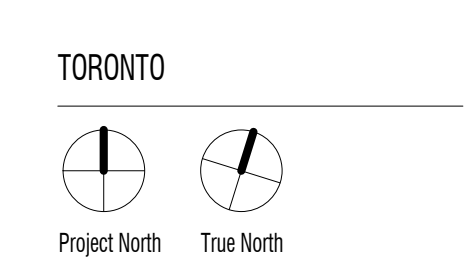

SCALE As Indicated
PROJECT NO. 202211
ISSUE DATE

**STREETScape
PLAN &
SECTIONS
L202**

- GENERAL NOTES:**
1. Drawings are not to be scaled. Contractor will verify all existing conditions and dimensions required to construct the work and will report any discrepancies with the Contract Documents to the Architect before commencing work.
 2. The Architect's Drawings are to be read in conjunction with all other Contract Documents including the Project Manual and the Structural, Mechanical and Electrical Drawings. In cases of difference between the Contract Documents with respect to the quantity, sizes or scope of work, the greater shall apply.
 3. Positions of supports of Structural Mechanical or Electrical devices, fittings and valves are indicated on the Architectural Drawings. Locations shown on the Architectural Drawings shall govern over Mechanical and Electrical Drawings. Mechanical and Electrical items not clearly located will be located as directed by the Architect.
 4. Dimensions indicated on plans between the faces of finished surfaces unless otherwise noted.
 5. The Architect has not been retained for supervision of construction and assumes no responsibility for means, methods and techniques of construction.
 6. These documents are not to be used for construction unless specifically noted for such purpose.

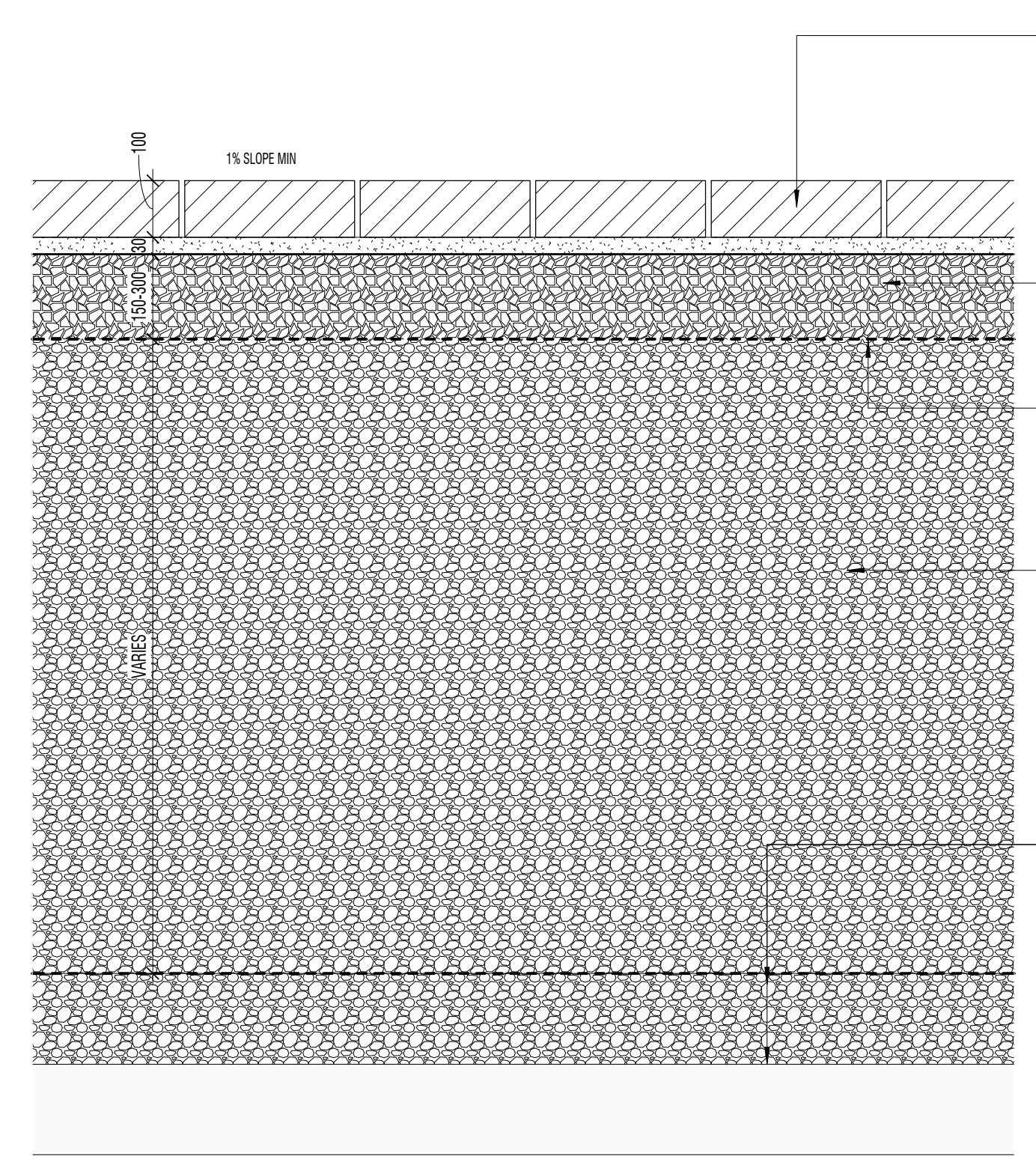

12 TYP. PAVER ASSEMBLY
L401 1:10

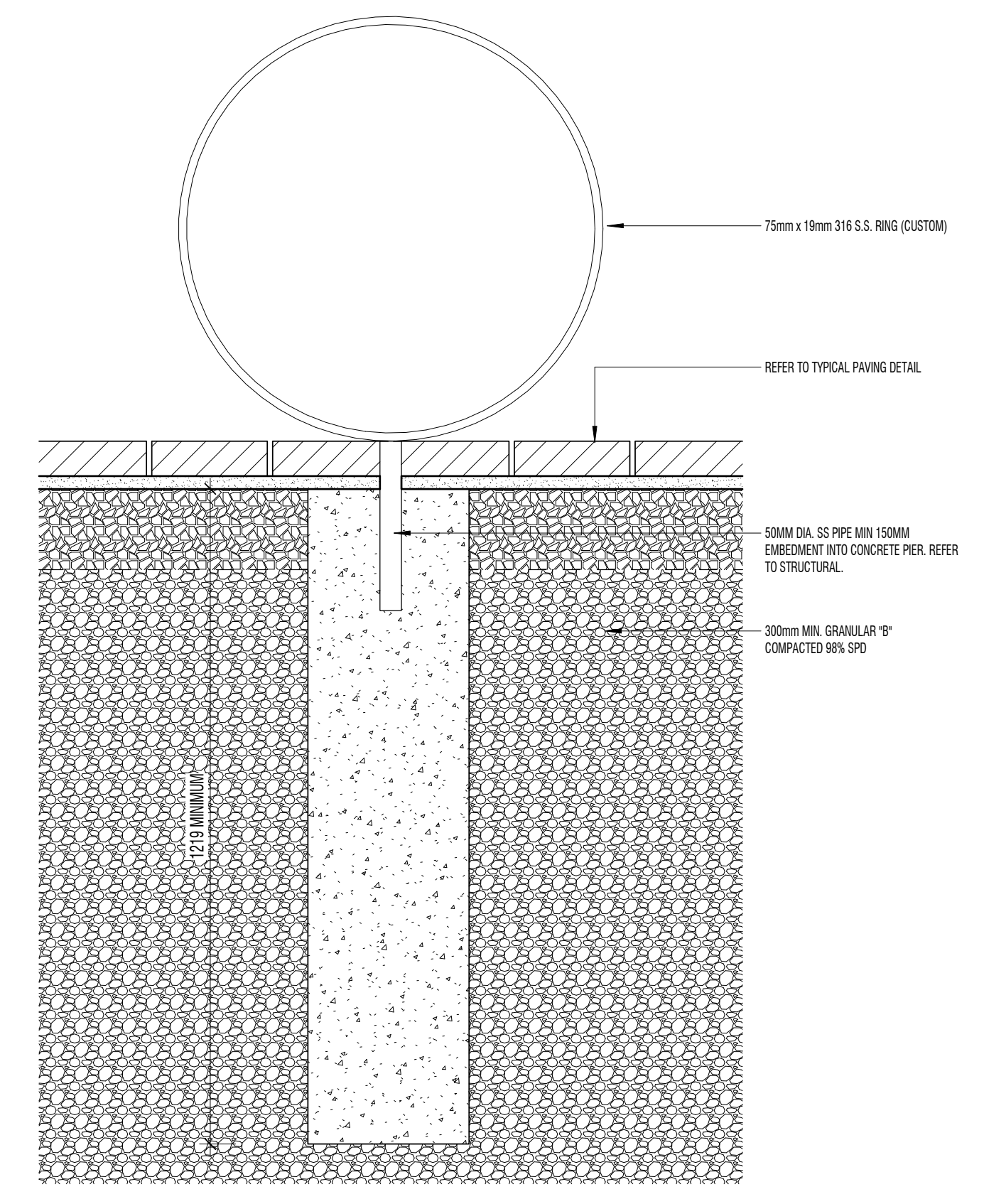

11 TYP. BIKE RACK DETAIL
L401 1:10

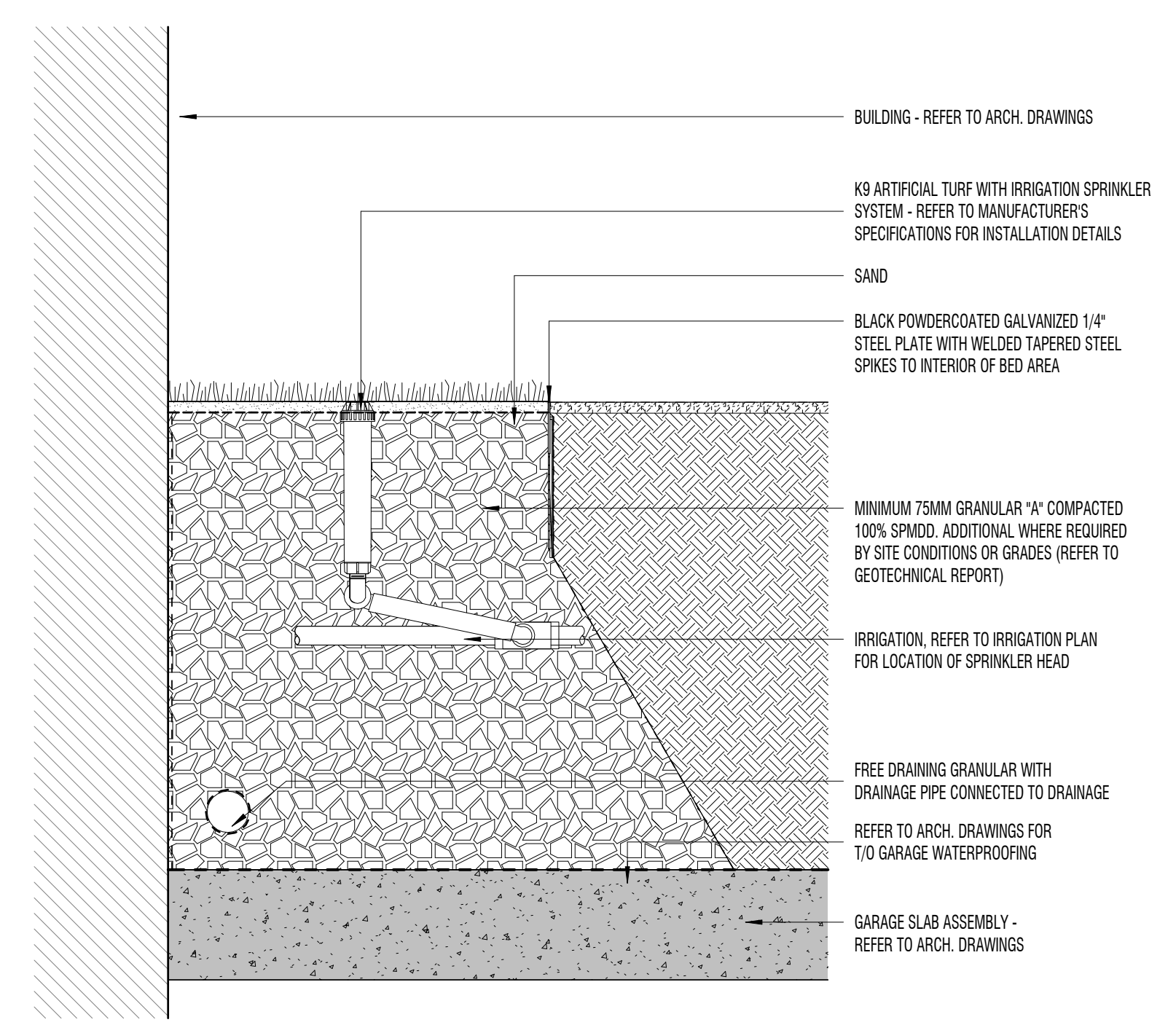

10 TYP. DOG RELIEF AREA DETAIL
L401 1:20

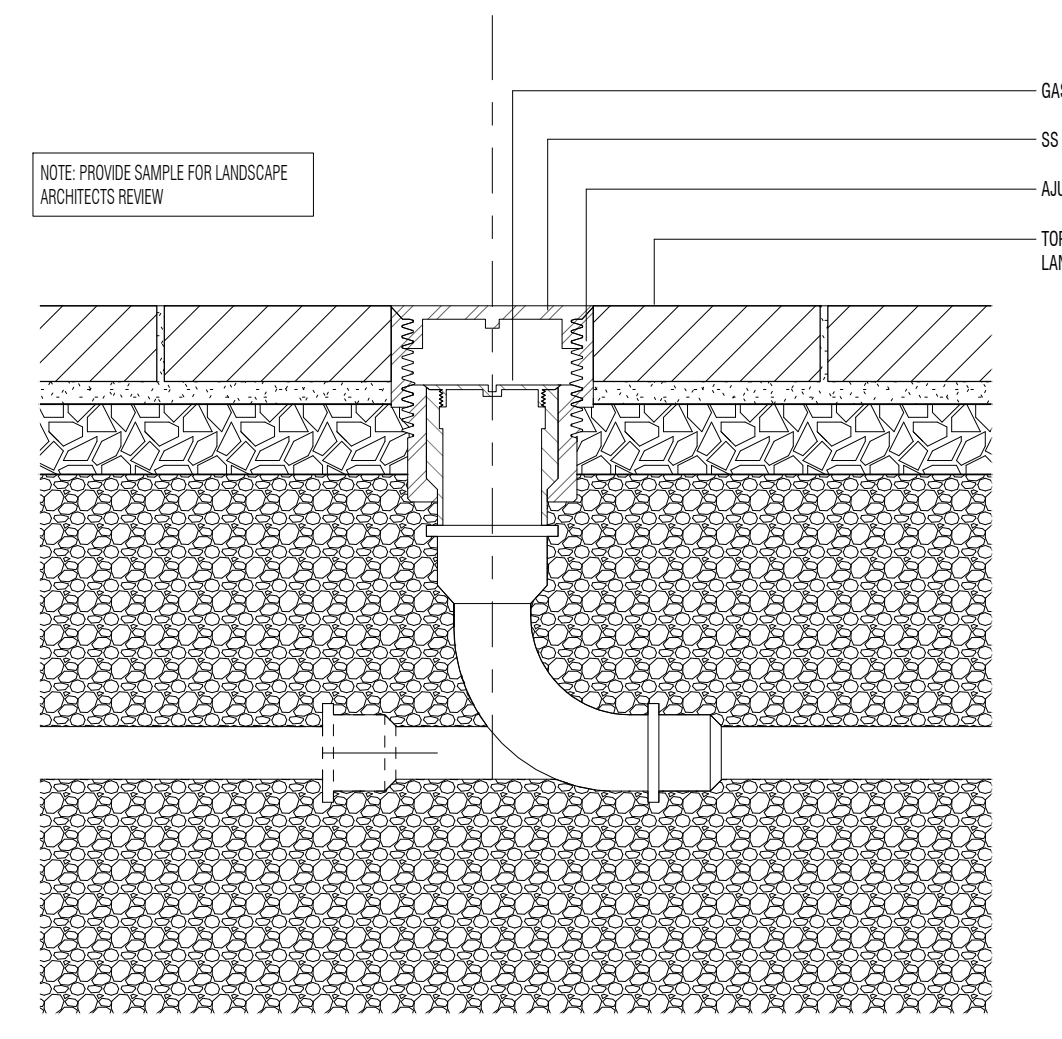

9 TYP. CLEAN-OUT WITH CAP IN PAVING
L401 1:10

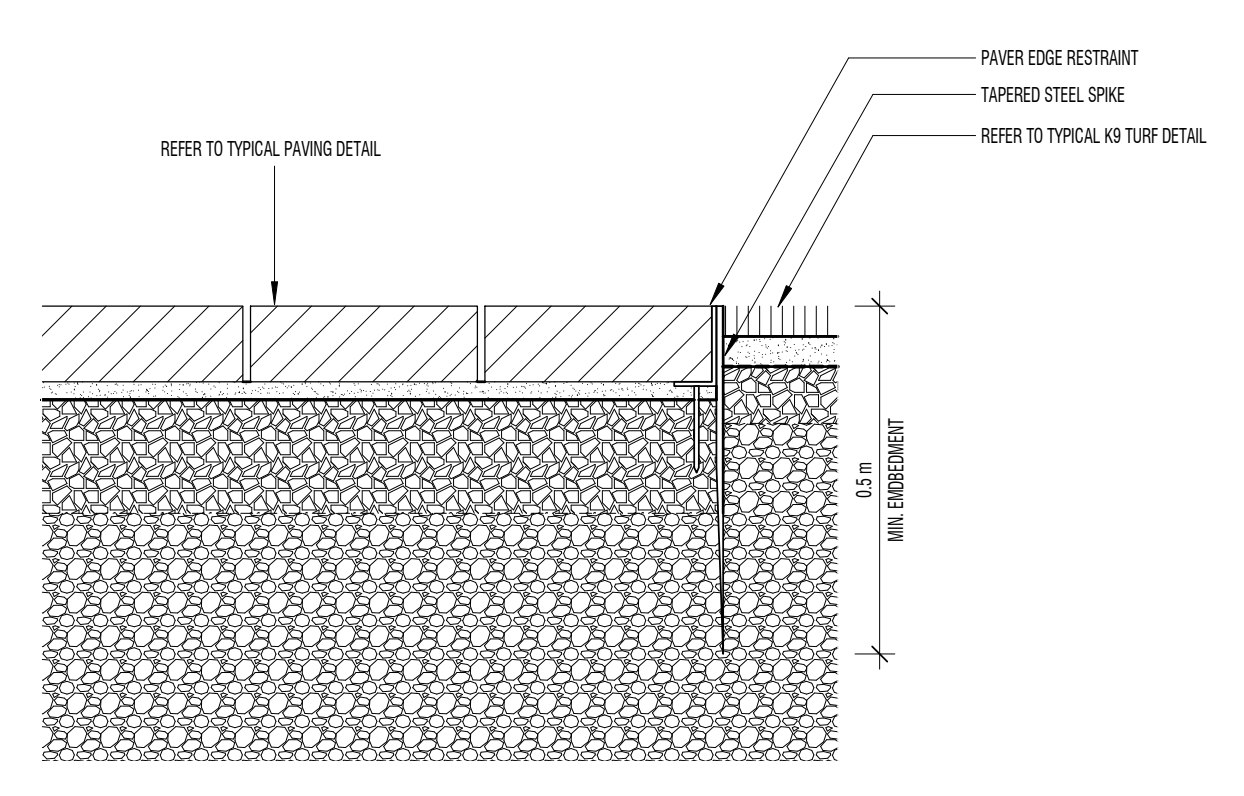

8 K9 TURF EDGE DETAIL
L401 1:10

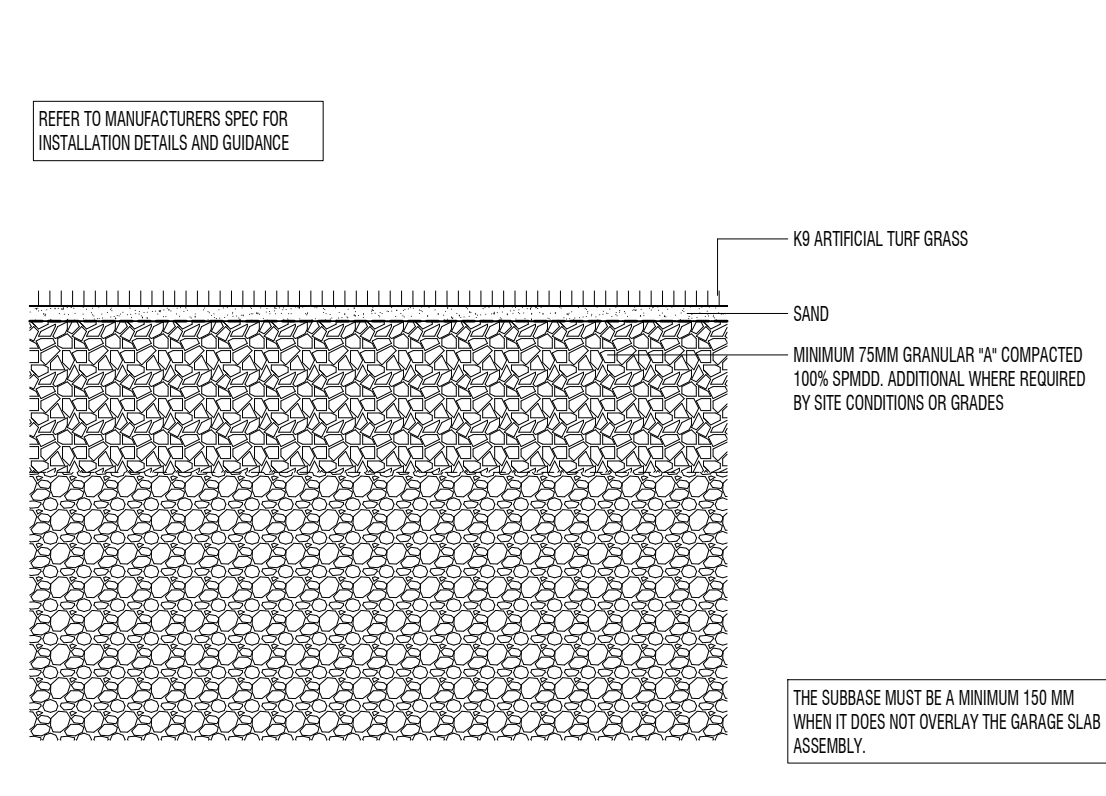

7 TYP. K9 TURF DETAIL
L401 1:20

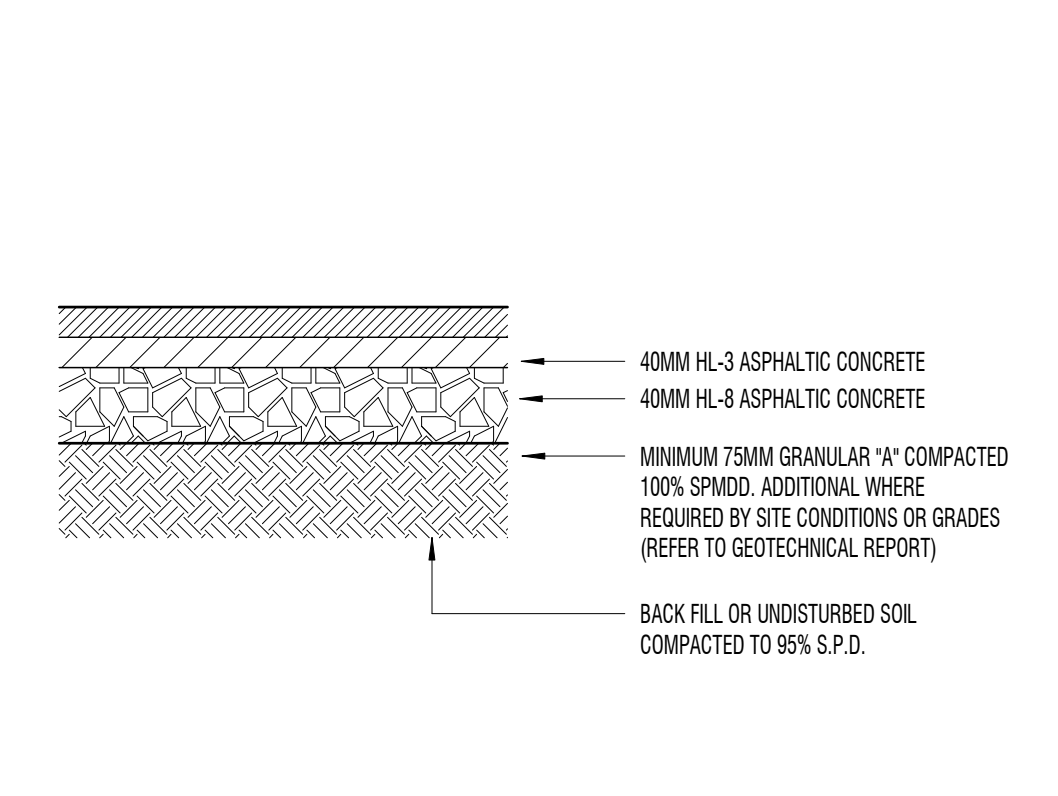

6 TYP. ASPHALT PAVING DETAIL
L401 1:10

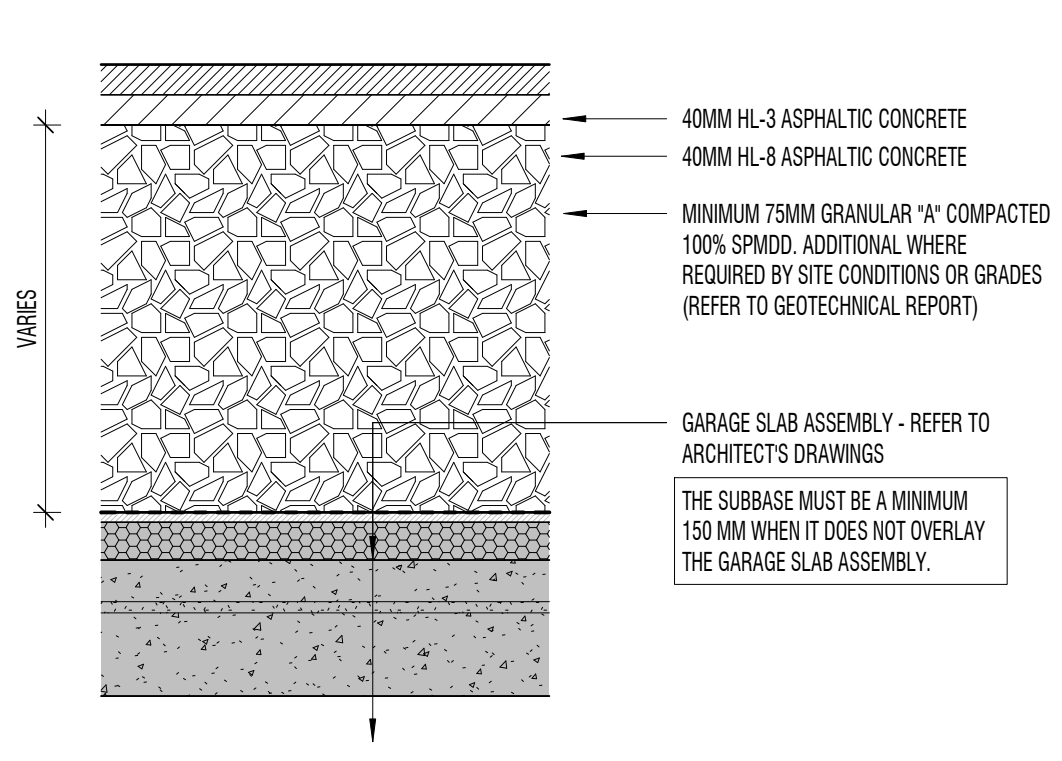

5 TYP. ASPHALT PAVING DETAIL OVER STRUCTURE
L401 1:10

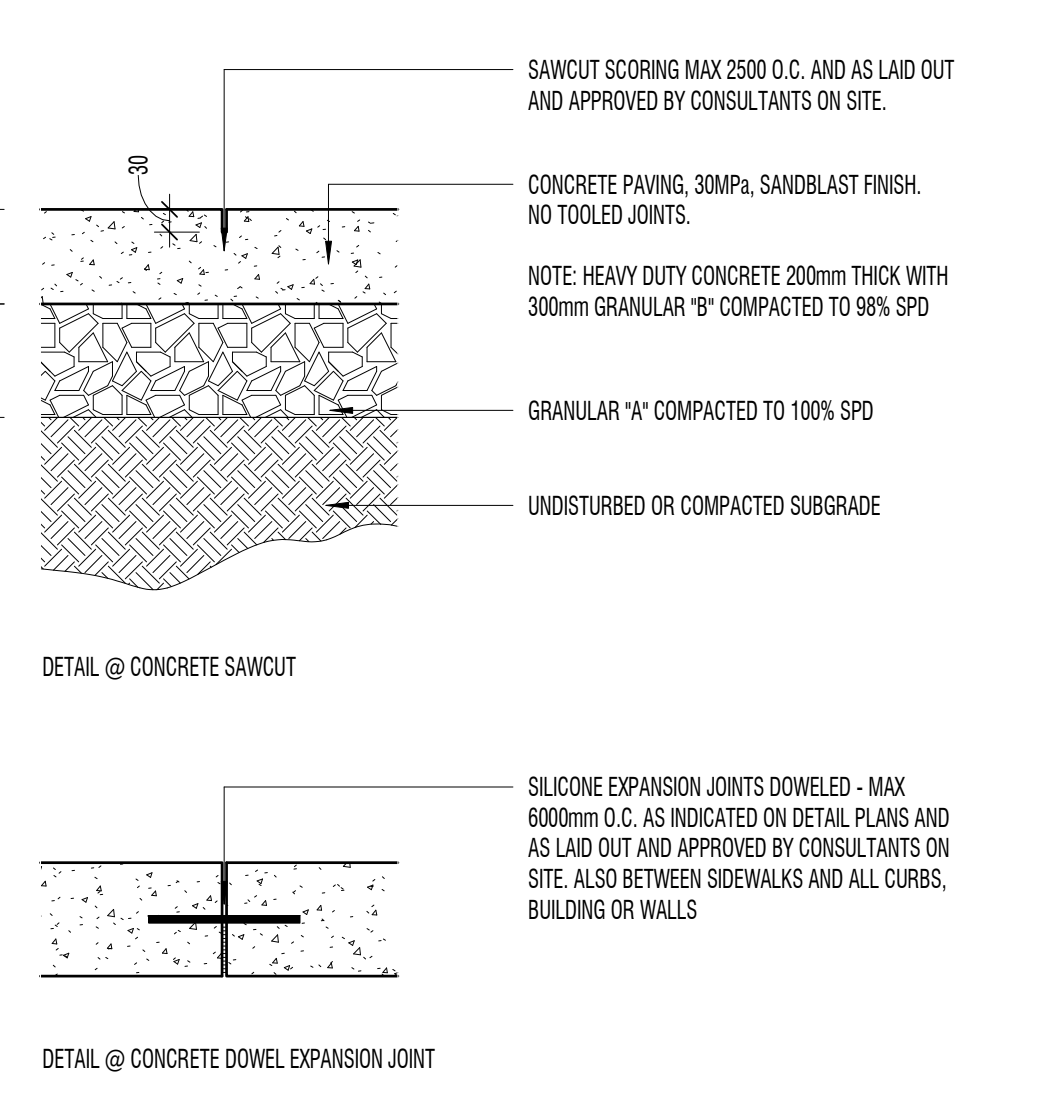

4 TYP. CONCRETE SIDEWALKS
L401 1:10

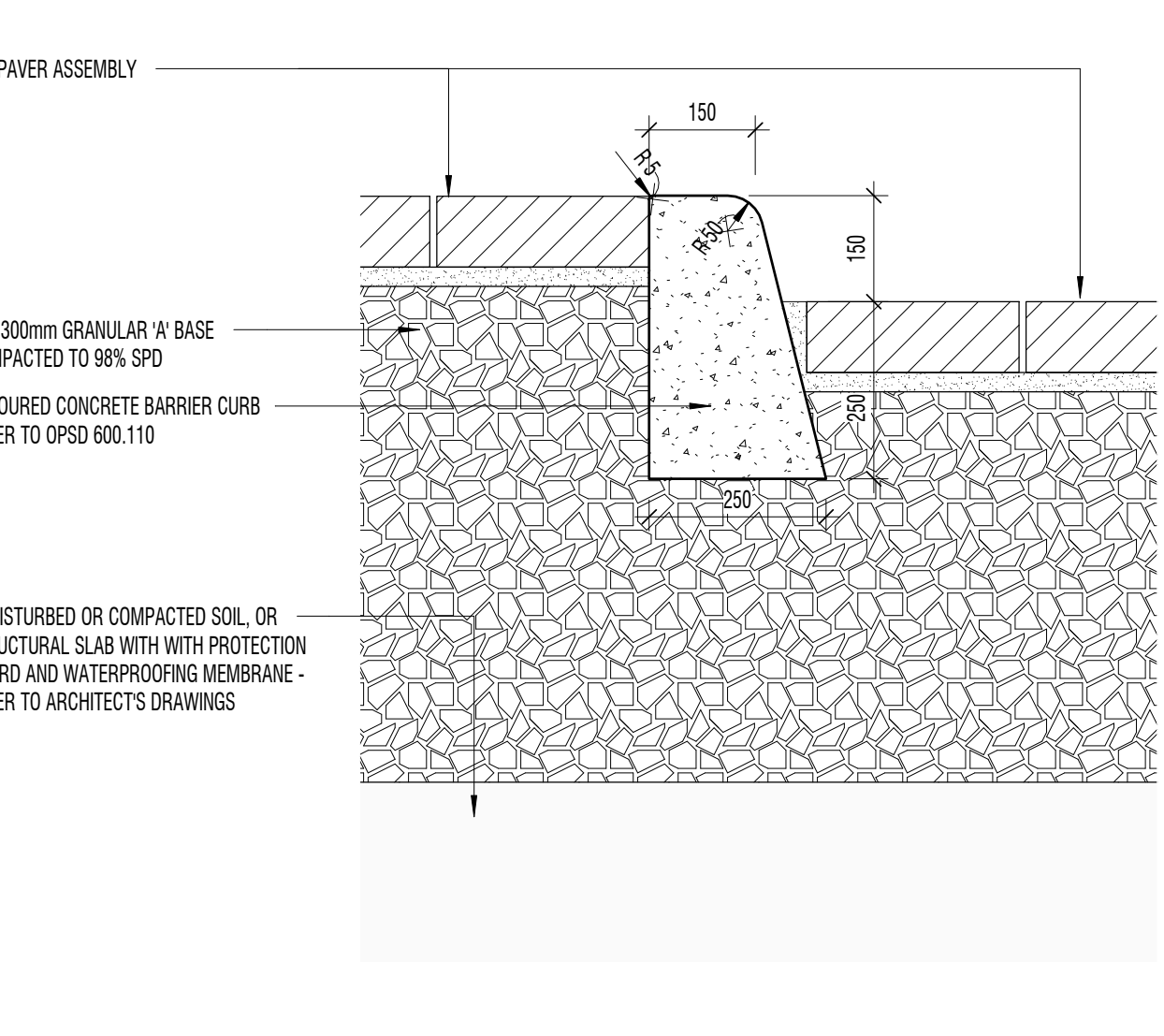

3 TYP. BARRIER CURB DETAIL
L401 1:10

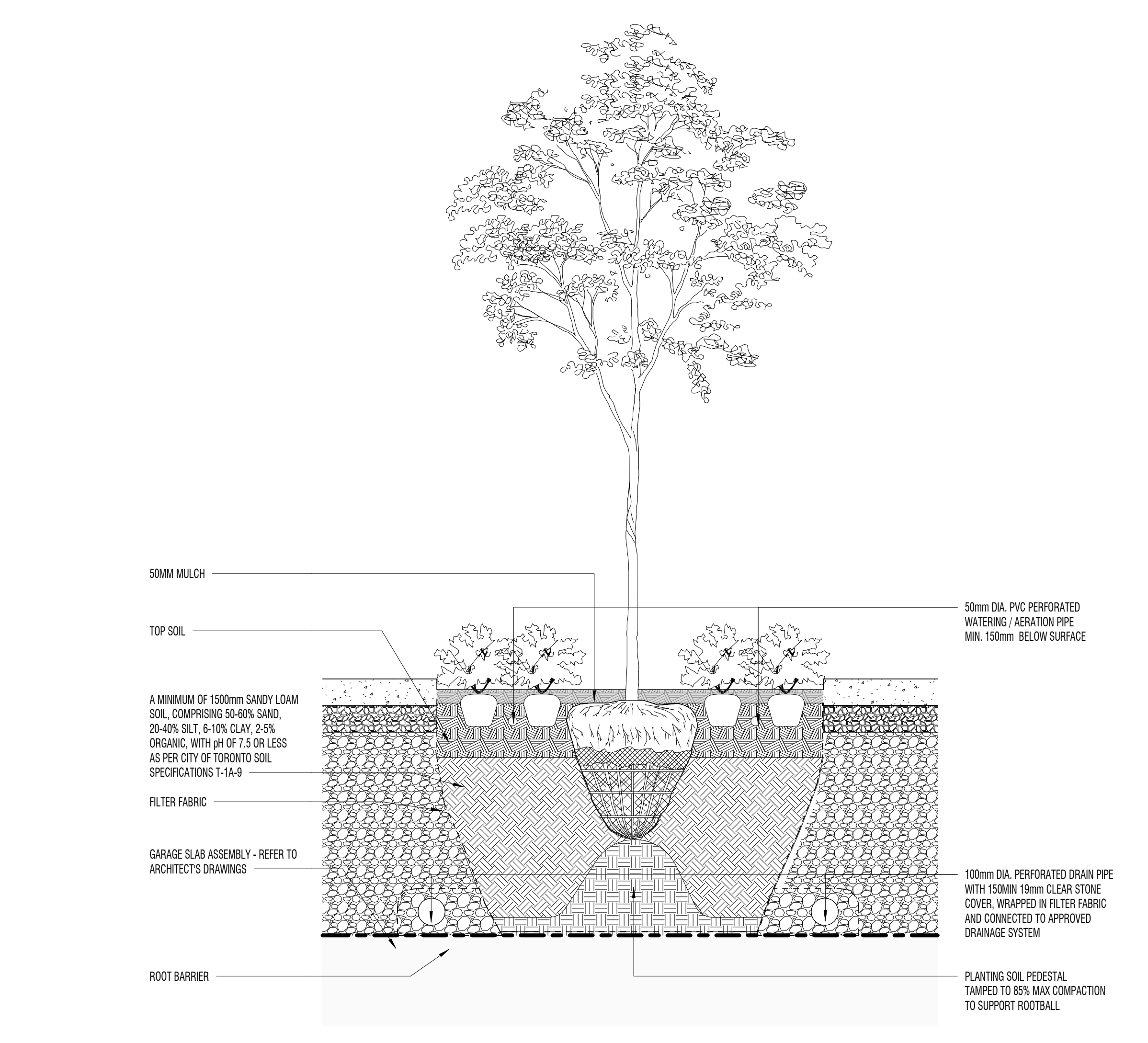

2 TYP. TREE IN PLANTING BED
L401 1:20

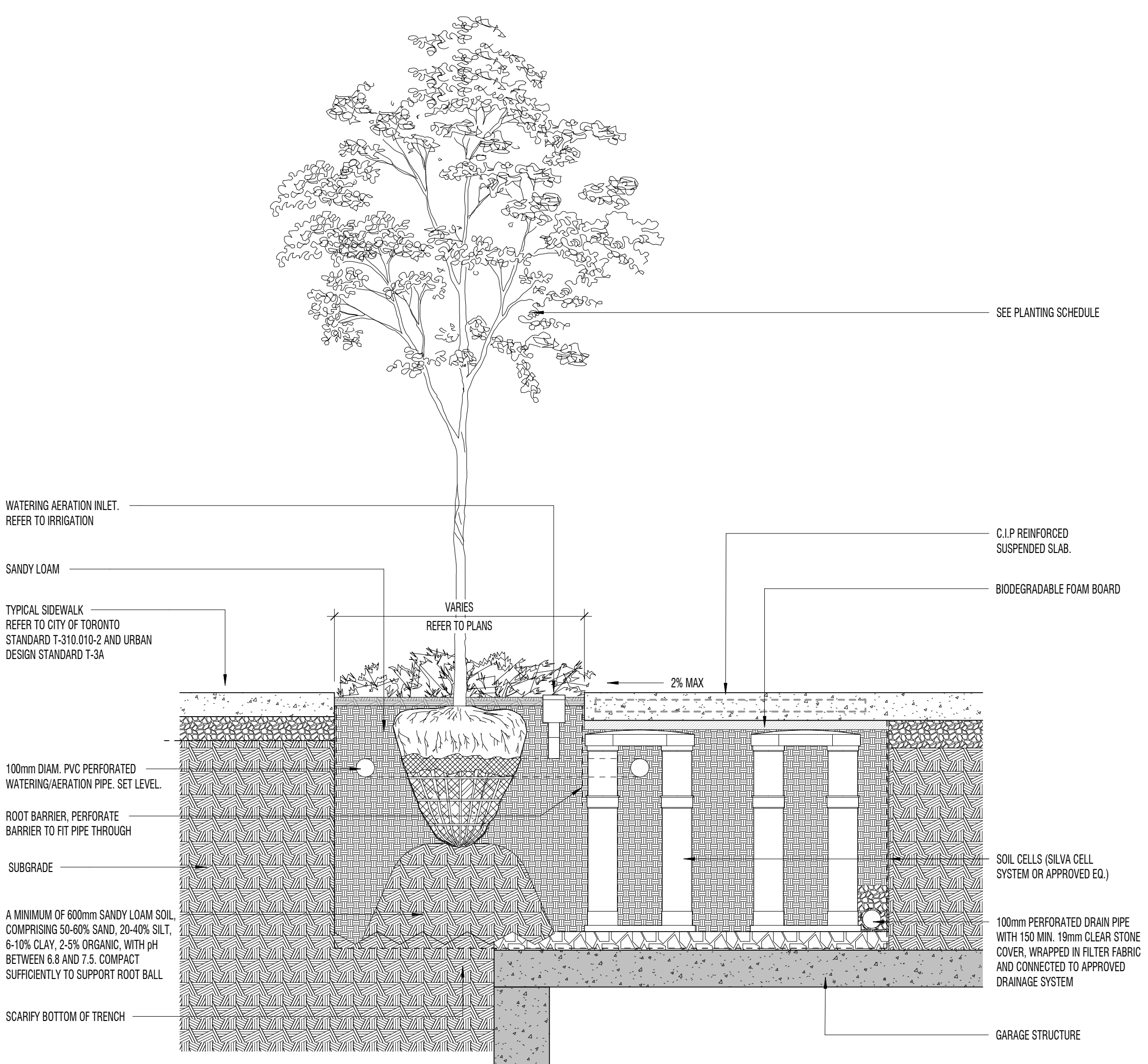

1 TYP. SOIL CELLS PLANTING
L401 1:20



gh3
55 OSSINGTON AVE. SUITE 100
TORONTO, ON, CANADA M5G 2Y9
416 915 1701

COLLECTEDV
3400 DUFFERIN STREET

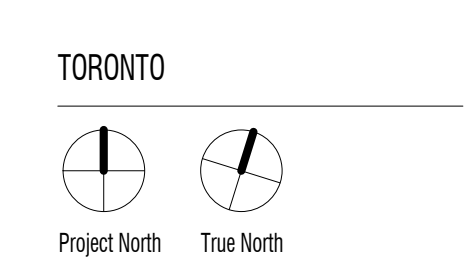

SCALE As indicated
PROJECT NO. 202211
ISSUE DATE

LANDSCAPE DETAILS

Copyright is that of the Architect.
 Any version of this drawing reproduced by any means from any media without prior written approval of the Architect is to be read for information only.
 The Architect is not liable for any loss or distortion of information resulting from subsequent reproduction of the original drawing.
 GENERAL NOTES:
 1. Drawings are not to be scaled. Contractor will verify all existing conditions and dimensions required to perform the Work and will report any discrepancies with the Contract Documents to the Architect before commencing work.
 2. The Architectural Drawings are to be read in conjunction with all other Contract Documents including the Project Manual and the Structural, Mechanical and Electrical Drawings. Location shown on the Architectural Drawings shall govern over Mechanical and Electrical Drawings. Mechanical and Electrical items not clearly located will be located as directed by the Architect.
 3. Dimensions indicated are taken between the faces of finished surfaces unless otherwise noted.
 4. The Architect has not been retained for supervision of construction and assumes no responsibility for means, methods and techniques of construction.
 5. These documents are not to be used for construction unless specifically noted for such purpose.

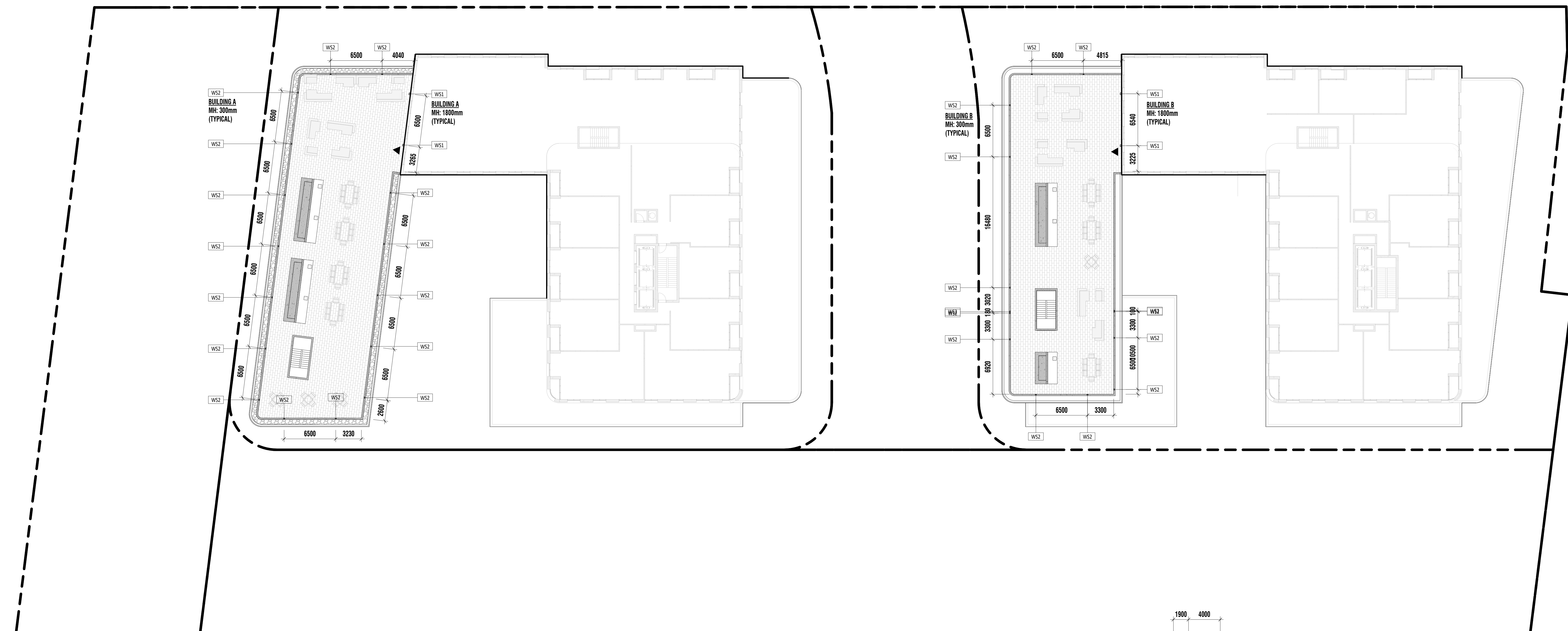

1 LEVEL 7 LIGHTING PLAN
 A300 LE102 1 : 200

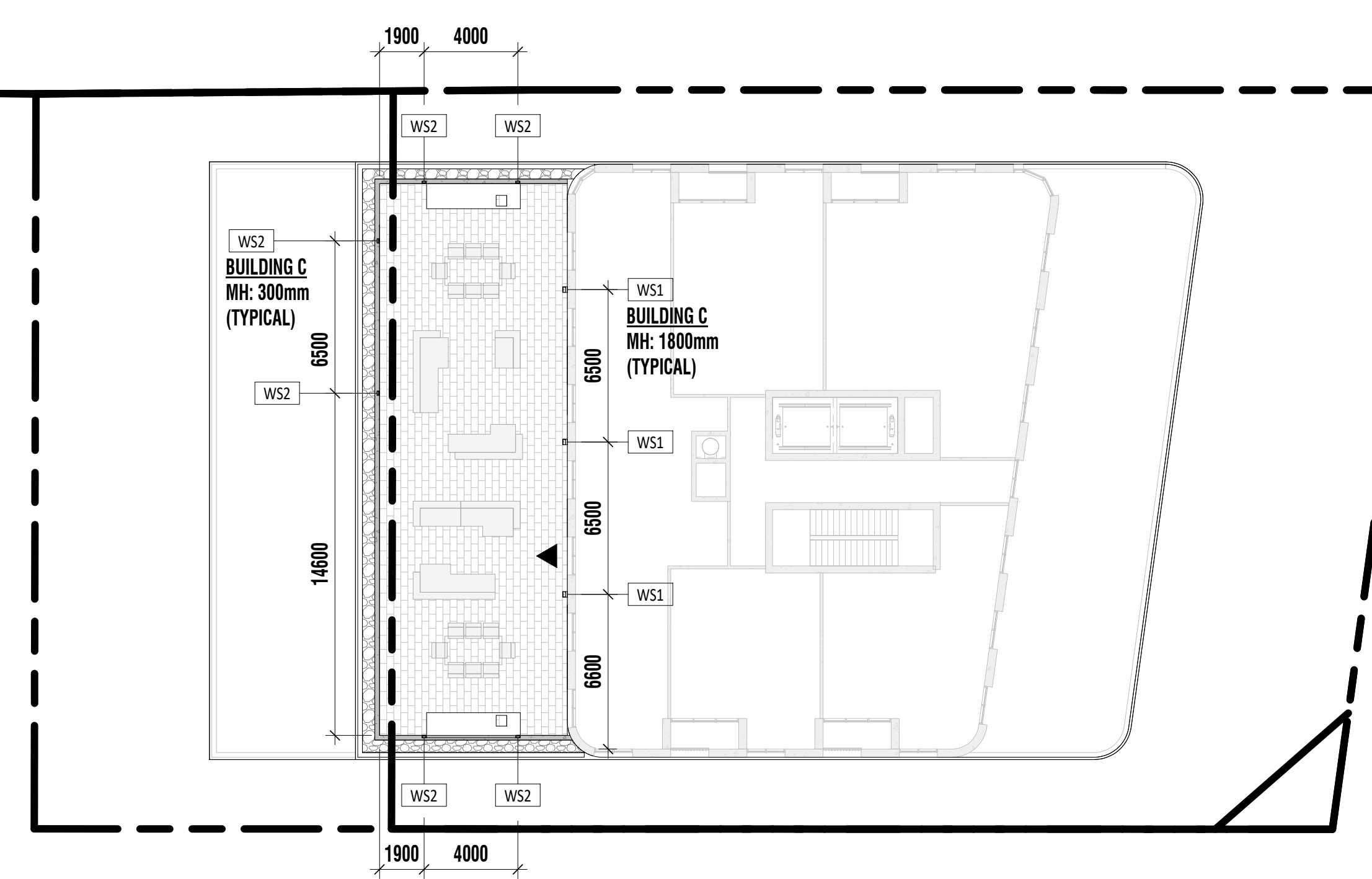

LIGHT FIXTURE SCHEDULE				
Type Mark	Type Comments	Count	Lamp	
Level 1				
LT	Compatible with 4", 5" and 6" pole diameters only	15		
WS1	TPL BEGA USA 22-383 - TYPE II	67	15.8W LED	
Level 7				
WS1	TPL BEGA USA 22-383 - TYPE II	7	15.8W LED	
WS2	© 2017 BEGA. Technical amendments reserved.	36	LED 4.8 W	
Level 8				
WS1	TPL BEGA USA 22-383 - TYPE II	4	15.8W LED	
WS2	© 2017 BEGA. Technical amendments reserved.	16	LED 4.8 W	
		145		

NOTE: SELECTED FIXTURES ARE FULL CUT-OFF AND HAVE A COLOUR TEMPERATURE EQUAL TO OR LESS THAN 3000K.

WS1

LED wall luminaire - wide spread light distribution

Application: The LED wall luminaire with a wide spread light distribution can be used to illuminate general purpose areas along walls. Can be used for airport or overnight applications.
Materials: Luminaires housing constructed of die-cast marine grade, copper free 2024-T3 magnesium alloy. Reflector made of pure anodized aluminum. Silicone applied internally to sealing elements for increased protection.
Features: High temperature silicone gasket. Mechanically sealed stainless steel fasteners. NEMA rated to North American Standards, suitable for wet locations. Protection class IP65.
Weight: 3.5 lbs.
Electrical: Operating voltage: 100-277VAC. Minimum start temperature: -20°C. LED module voltage: 24-28V. System output: 21 W. Controllability: 0-100% dimmable. Color rendering index: 90 Ra. Luminaire lifetime: 215k hours (D0000). LED service life: 50,000 hours.
LED color temperature: □ D0000 - Product number: **W4**
 □ 2000K - Product number: **W5**
 □ 3000K - Product number: **W6**
 □ 4000K - Product number: **W7**
 □ 5000K - Product number: **W8**
Warranty: Five-year LED - Optional.
Luminaire: is adjustable, available with a narrow beamwidth, ambient LED source (5000K) compliant with the FCC. This light fixture is engineered to use either direct or indirect lighting. Electrical and control information may vary from standard luminaires.
LED module voltage: 24-28V (direct).
System voltage: 100-277V (indirect).
LED luminaire lifetime: 215k hours (D0000).
LED service life: 50,000 hours.
Finish: All BEGA standard finishes are made, textured stainless powder coat with minimum 0.4 mil thickness.
Available color: Black (BK) White (WH) RAL Bronze (BR) Silver (SL) OUB OUB

Type: BEGA Product: Modulist



WS2

Recessed wall luminaire - shielded

Application: Recessed wall luminaire with shielded light distribution for glare free illumination of general purpose, tasking, corridors, stairs and bathroom applications.
Materials: Luminaires housing and bezel constructed of die-cast marine grade, copper free 2024-T3 magnesium alloy. Reflector made of pure anodized aluminum. Silicone applied internally to sealing elements for increased protection.
Features: High temperature silicone gasket. Mechanically sealed stainless steel fasteners. NEMA rated to North American Standards, suitable for wet locations. Protection class IP65.
Weight: 3.5 lbs.
Electrical: Operating voltage: 100-277VAC. Minimum start temperature: -20°C. LED module voltage: 24-28V. System output: 21 W. Controllability: 0-100% dimmable. Color rendering index: 90 Ra. Luminaire lifetime: 215k hours (D0000). LED service life: 50,000 hours.
LED color temperature: □ D0000 - Product number: **W4**
 □ 2000K - Product number: **W5**
 □ 3000K - Product number: **W6**
 □ 4000K - Product number: **W7**
 □ 5000K - Product number: **W8**
Warranty: Five-year LED - Optional.
Luminaire: is adjustable, available with a narrow beamwidth, ambient LED source (5000K) compliant with the FCC. This light fixture is engineered to use either direct or indirect lighting. Electrical and control information may vary from standard luminaires.
LED module voltage: 24-28V (direct).
System voltage: 100-277V (indirect).
LED luminaire lifetime: 215k hours (D0000).
LED service life: 50,000 hours.
Finish: All BEGA standard finishes are made, textured stainless powder coat with minimum 0.4 mil thickness.
Available color: Black (BK) White (WH) RAL Bronze (BR) Silver (SL) OUB OUB

Type: BEGA Product: Modulist

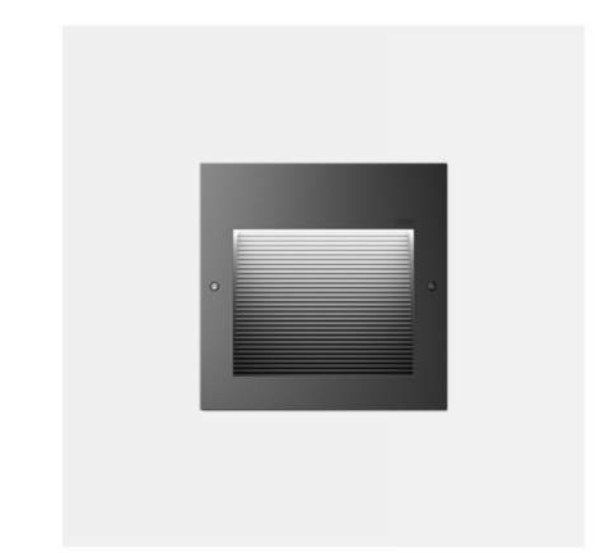

1 Aug 09, 2022 ISSUE FOR ZBA & SPA
 Rev. Date Issued



gh3
 35 OSSINGTON AVE, SUITE 100
 TORONTO, ON, CANADA M5J 2Y9
 416-915-1791

COLLECTEDV
 3400 DUFFERIN STREET

TORONTO
 Project North True North

SCALE 1 : 200
 PROJECT NO. 202211
 ISSUE DATE

LEVEL 7
 LIGHTING PLAN

LE102



1 LEVEL 8 LIGHTING PLAN
A300 LE103 1 : 200

LIGHT FIXTURE SCHEDULE			
Type Mark	Type Comments	Count	Lamp
Level 1			
LT1	Compatible with 4", 5" and 6" pole diameters only	15	
WS1	TPL BEGA USA 22 383 - TYPE II	67	15.8W LED
Level 7			
WS1	TPL BEGA USA 22 383 - TYPE II	7	15.8W LED
WS2	© 2017 BEGA. Technical amendments reserved.	36	LED 4.8 W
Level 8			
WS1	TPL BEGA USA 22 383 - TYPE II	4	15.8W LED
WS2	© 2017 BEGA. Technical amendments reserved.	16	LED 4.8 W
		145	

NOTE: SELECTED FIXTURES ARE FULL CUT-OFF AND HAVE A COLOUR TEMPERATURE EQUAL TO OR LESS THAN 3000K.

WS1

LED wall luminaire - wide spread light distribution

Application
This LED wall luminaire with a wide spread light distribution can be used to illuminate ground surfaces along walls. Can be used for ceiling or downlight applications.

Materials
Luminaire housing constructed of die-cast marine grade, copper free (CZ) or copper content (A6063) aluminum alloy.
Clear acrylic glass with optional bronze or silver anodized aluminum.
Reflector made of pure anodized aluminum.
High temperature silicone gasket.
Mechanically replace stainless steel fasteners.
NEMA tested to North American Standards, suitable for wet locations.
Protection class IP65.
Weight: 6.8 lbs

Electrical
Quantity voltage: 100-277VAC
Minimum ambient temperature: 32°F / 0°C
LED module voltage: 54.0V
System voltage: 277V
Connectability: 0-10V dimmable
Colour rendering index: RA8
Luminaire length: 21.87 lumens (5000K)
LED module life: 50,000 hours

LED color temperature
□ 3000K - Product number: **K4**
□ 3500K - Product number: **K5**
□ 4000K - Product number: **K6**
□ 5000K - Product number: **K7**
□ 6000K - Product number: **K8**

Wide-Nearly-gentle LED - Optional
Luminaire is optionally available with a warm beamwidth, wider LED source (50° beam) approved by the IESNA. The light output is regulated by our wide color technology to keep light levels and lighting uniform. Electrical and control information may vary from standard luminaire.
LED module voltage: 54.0V (fixed)
System voltage: 277V (range)
Luminaire length: 60.2 lumens (range)

Finish
All BEGA standard finishes are matte, textured powder coat with minimum 0.1 mil thickness. BEGA standard finish is a fluoropolymer technology, provides superior finish protection. Black, Bronze, and Silver BEGA standard finish, as well as optional available PUL and custom colors, are a polymer powder.
Available colors: Black (BLK) White (AWT) PUL Bronze (BRZ) Silver (SLV) CUS

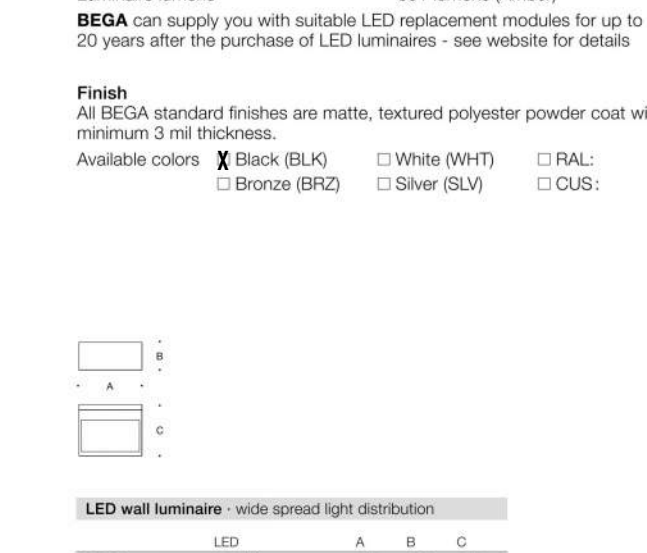

BEGA 1000 BEGA Way, Carpinteria, CA 93013 805.664.0333 #begausa-usa.com

WS2

Recessed wall luminaire - shielded

Application
This LED luminaire with shielded light distribution for glass free illumination of ground surfaces, building entrance, stairs and pathways.

Materials
Luminaire housing and fastener constructed of die-cast marine grade, copper free (CZ) or copper content (A6063) aluminum alloy.
Clear acrylic glass with optional bronze or silver anodized aluminum.
High temperature silicone gasket.
Mechanically replace stainless steel fasteners.
Stainless steel screw cap.
Complete protection housing.
NEMA tested to North American Standards, suitable for wet locations.
Protection class IP65.
Weight: 3.3 lbs

Electrical
Quantity voltage: 100-277VAC
Minimum ambient temperature: 32°F / 0°C
LED module voltage: 4.8V
System voltage: 277V
Connectability: 0-10V dimmable
Colour rendering index: RA8
Luminaire length: 18.8 lumens (4000K)
LED module life: 50,000 hours

LED color temperature
□ 3000K - Product number: **K4**
□ 3500K - Product number: **K5**
□ 4000K - Product number: **K6**
□ 5000K - Product number: **K7**
□ 6000K - Product number: **K8**

Finish
All BEGA standard finishes are matte, textured powder coat with minimum 0.1 mil thickness. BEGA standard finish is a fluoropolymer technology, provides superior finish protection. Black, Bronze, and Silver BEGA standard finish, as well as optional available PUL and custom colors, are a polymer powder.
Available colors: Black (BLK) White (AWT) PUL Bronze (BRZ) Silver (SLV) CUS

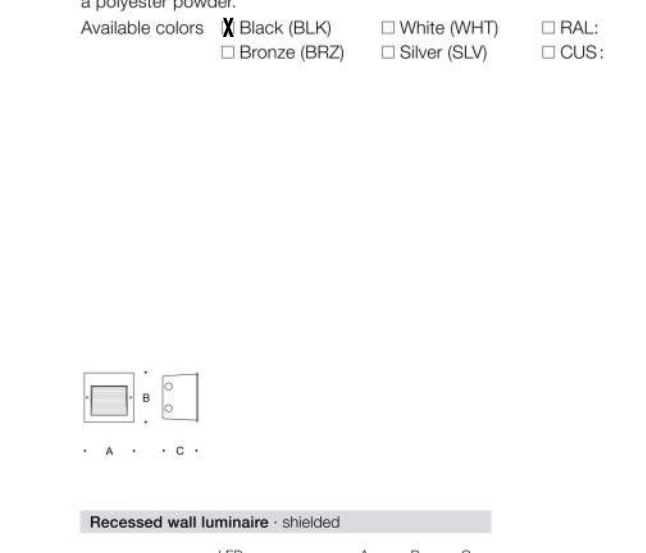

BEGA 1000 BEGA Way, Carpinteria, CA 93013 805.664.0333 #begausa-usa.com

Copyright is that of the Architect.
Any version of this drawing reproduced by any means from any media without prior written approval of the Architect is to be used for information only.
The Architect is not liable for any loss or distortion of information resulting from subsequent reproduction of the original drawing.
GENERAL NOTES:
1. Drawings are not to be scaled. Contractor will verify all existing conditions and dimensions required to perform the work and will report any discrepancies with the Contract Documents to the Architect before commencing work.
2. The Architectural Drawings are to be read in conjunction with all other Contract Documents including the Project Manual and the Structural, Mechanical and Electrical Drawings. In cases of difference between the Contract Documents with respect to the quantity, sizes or scope of work, the greater shall apply.
3. Positions of exposed or finished Mechanical or Electrical devices, fittings and valves are indicated on the Architectural Drawings. Locations shown on the Architectural Drawings shall govern over Mechanical and Electrical Drawings. Mechanical and Electrical items not clearly located will be located as directed by the Architect.
4. Dimensions indicated on plans between the faces of finished surfaces unless otherwise noted.
5. The architect has not been retained for approval of construction and assumes responsibility for means, methods and techniques of construction.
6. These documents are not to be used for construction unless specifically noted for such purpose.

1 Aug 09, 2022 ISSUE FOR EBA & SPA
Rev. Date Issue



gh3
35 OSSINGTON AVE, SUITE 100
TORONTO, ON, CANADA M5S 2Y9
416 915 1701

COLLECTEDV
3400 DUFFERIN STREET

TORONTO
Project North True North

SCALE 1:200
PROJECT NO. 202211
ISSUE DATE

LEVEL 8
LIGHTING PLAN

LE103